

# SSC



生聖股份有限公司  
Sheng Sheng Metal Co., Ltd.



ISSUE DATE: May 14, 2010

CERTIFICATE AUTHORIZATION NUMBER: 1540



THIS IS TO CERTIFY THAT

**GHWA Industries Co. Ltd**

SV City Tower 1, 20th Floor, 896/34 Rama 3 Road, Bangpongpan, Bangkok 10120, Thailand

is hereby authorized to continue to apply the  
3-A Symbol to the models of equipment, conforming to 3-A Sanitary Standards for:

Number 63-03  
63-03 (Sanitary Fittings)

set forth below

Both CIP and COP Models: 242SA,B,C or Dxxx-yz; 242WCLA,B,C or Dxxx-yz; 242KSA,B,C or Dxxx-yz; 242WKA,B,C or Dxxx-yz; 242WULA,B,C or Dxxx-yz; 247WA,B,C or Dxxx-yz; 247WWWA,B,C or Dxxx-yz; 249WA,B,C or Dxxx-yz; 249WWWWA,B,C or Dxxx-yz; 247WTA,B,C or Dxxx-yz; 247WWWTA,B,C or Dxxx-yz; 247RWA,B,C or Dxxx-yz; 247RWWWA,B,C or Dxxx-yz; 247RWTA,B,C or Dxxx-yz; 247RWWWTA,B,C or Dxxx-yz; 2431WA,B,C or Dxxx-yz; 2432WA,B,C or Dxxx-yz; 2431A,B,C or Dxxx-yz; 2432A,B,C or Dxxx-yz; 242CMPLA,B,C or Dxxx-yz; 242CMPA,B,C or Dxxx-yz; 242KMPLA,B,C or Dxxx-yz; 242KMPA,B,C or Dxxx-yz; 247MPA,B,C or Dxxx-yz; 247MPSA,B,C or Dxxx-yz; 249MPA,B,C or Dxxx-yz; 247RMPA,B,C or Dxxx-yz; 247RMPSA,B,C or Dxxx-yz; 2431MPA,B,C or Dxxx-yz; 2432MPA,B,C or Dxxx-yz; 2414AMPA,B,C or Dxxx-yz; 2414WMPA,B,C or Dxxx-yz; 2414MMPA,B,C or Dxxx-yz; 2416WA,B,C or Dxxx-yz; 2416AMPA,B,C or Dxxx-yz; 2414PRFA,B,C or Dxxx-yz; 2414AA,B,C or Dxxx-yz; 2414WLA,B,C or Dxxx-yz; 2414WA,B,C or Dxxx-yz; 2415TRFA,B,C or Dxxx-yz; 2415AA,B,C or Dxxx-yz; 2415WLA,B,C or Dxxx-yz; 2415WA,B,C or Dxxx-yz; 2416AA,B,C or Dxxx-yz; 247WWTA,B,C or Dxxx-yz; 247WTTA,B,C or Dxxx-yz; 247WTWA,B,C or Dxxx-yz; 247TTWA,B,C or Dxxx-yz; 242TA,B,C or Dxxx-yz; 242KTA,B,C or Dxxx-yz; 242FPA,B,C or Dxxx-yz; 242KPA,B,C or Dxxx-yz; 242FMP14A,B,C or Dxxx-yz; 2417MP14A,B,C or Dxxx-yz; 2417MP15A,B,C or Dxxx-yz; 243115FA,B,C or Dxxx-yz; 2431TTA,B,C or Dxxx-yz; 2431TPA,B,C or Dxxx-yz; 2414C31A,B,C or Dxxx-yz; 2428WAA,B,C or Dxxx-yz; 2428WA,B,C or Dxxx-yz; 2428AMPA,B,C or Dxxx-yz; 2428BMPA,B,C or Dxxx-yz; 2207A,B,C or Dxxx-yz; 2208A,B,C or Dxxx-yz; 2209A,B,C or Dxxx-yz; 2210A,B,C or Dxxx-yz; 2211CA,B,C or Dxxx-yz; 2211EA,B,C or Dxxx-yz; 2222AA,B,C or Dxxx-yz; 2222BA,B,C or Dxxx-yz; 2222CA,B,C or Dxxx-yz; Where y and z are: 1, 2, 3, 4, or 5.

VALID THROUGH: **December 31, 2019**

Timothy R. Rugh  
Executive Director  
3-A Sanitary Standards, Inc.

The issuance of this authorization for the use of the 3-A Symbol is based upon the voluntary certification, by the applicant for it, that the equipment listed above complies fully with the 3-A Sanitary Standard(s) designated. Legal responsibility for compliance is solely that of the holder of this Certificate of Authorization, and 3-A Sanitary Standards, Inc. does not warrant that the holder of an authorization at all times complies with the provisions of the said 3-A Sanitary Standards. This in no way affects the responsibility of 3-A Sanitary Standards, Inc. to take appropriate action in such cases in which evidence of nonconformance has been established.

NEXT TPV INSPECTION/REPORT DUE: **April 2022**

ISSUE DATE: May 08, 2015

CERTIFICATE AUTHORIZATION NUMBER: 1817



THIS IS TO CERTIFY THAT

GHWA Industries Co. Ltd

SV City Tower 1, 20th Floor, 896/34 Rama 3 Road, Bangpongpan, Bangkok 10120 , Thailand

is hereby authorized to continue to apply the  
3-A Symbol to the models of equipment, conforming to 3-A Sanitary Standards for:

Number 33-03  
33-03 (Metal Tubing)

set forth below

Both CIP and COP Models: 2401A or Bxxxxyy-z1, where z is: 1, 2, 3, 4, or 5; 2201Bxxxxyy-F1 or 4.

VALID THROUGH: **December 31, 2019**

Timothy R. Rugh  
Executive Director  
3-A Sanitary Standards, Inc.

The issuance of this authorization for the use of the 3-A Symbol is based upon the voluntary certification, by the applicant for it, that the equipment listed above complies fully with the 3-A Sanitary Standard(s) designated. Legal responsibility for compliance is solely that of the holder of this Certificate of Authorization, and 3-A Sanitary Standards, Inc. does not warrant that the holder of an authorization at all times complies with the provisions of the said 3-A Sanitary Standards. This in no way affects the responsibility of 3-A Sanitary Standards, Inc. to take appropriate action in such cases in which evidence of nonconformance has been established.

NEXT TPV INSPECTION/REPORT DUE: **April 2022**



The American Society of Mechanical Engineers



BPE

## CERTIFICATE OF AUTHORIZATION

The named company is authorized by the American Society of Mechanical Engineers (ASME) for the scope shown below in accordance with the applicable rules of the ASME BPE Standard on Bioprocessing Equipment. The use of the certification mark and the authority granted by this Certificate of Authorization are subject to the provisions of the agreement set forth in the application. Any component certified under this authorization shall have been produced, assembled, and tested in accordance with the provisions of the aforementioned ASME standard.

COMPANY:

**G HWA Industries Co., Ltd.  
52 Moo 7 Nongchumpon  
Khaoyoi, Phetchaburi 76140  
Thailand**

SCOPE:

**Manufacturer of Ferrous Fittings and Tubing (excluding circumferential welds) at the above location only**

AUTHORIZED:

**January 20, 2016**

EXPIRES:

**January 20, 2021**

CERTIFICATE NUMBER: **BPE-107**

  
Vice President, Conformity Assessment

  
Director, Conformity Assessment



# index

<b>SANITARY FITTING</b> 衛生級管件	▷	05-14
<b>FERULE/BLANK</b> 夾接 / 盲板	▷	15-16
<b>FERRULE ADAPTER</b> 夾接轉接頭	▷	17
<b>FERRULE GASKET</b> 夾接密封圈	▷	18
<b>CLAMP</b> 管束	▷	19
<b>TUBE HANGER</b> 管固定夾	▷	20
<b>BPE FITTING</b> 生技醫藥級管件	▷	21-35
<b>BUTTERFLY VALVE</b> 蝶閥	▷	36-37
<b>ACTUATOR</b> 汽缸	▷	38
<b>BALL VALVE</b> 球閥	▷	39-43
<b>CHECK VALVE</b> 逆止閥	▷	44
<b>SAMPLE VALVE</b> 取樣閥	▷	45
<b>SPRAY BALL</b> 噴球	▷	46
<b>STRAINERES</b> 過濾器	▷	47
<b>PNEUMATIC SEAT VALVE</b> 氣動座閥	▷	48
<b>SIGHT GLASS</b> 玻璃視窗	▷	49
<b>DIAPHRAGM VALVE</b> 隔膜閥	▷	50-53
<b>UNION</b> 由任	▷	54-58
<b>VACUUM COMPONENTS</b> 真空管配件	▷	59-62



# SANITARY FITTING 衛生級管件

食品衛生管 (Tube ASTM A-270)

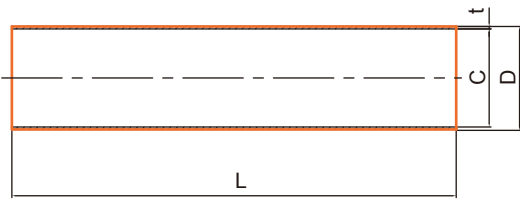

inch	C	D	t	L
1/2	12.70	9.4	1.65	6000
3/4	19.05	15.75	1.65	6000
1.0	25.40	22.1	1.65	6000
1 1/2	38.10	34.8	1.65	6000
2.0	50.80	47.5	1.65	6000
2 1/2	63.50	60.2	1.65	6000
3.0	76.20	72.9	1.65	6000
4.0	101.60	97.38	2.11	6000
6.0	152.40	146.86	2.77	6000

研光管規格 (IDF Tube)

Size	D	C	t	L
0.5	12.70	9.4	1.65	3000
0.75	19.05	15.75	1.65	3000
1.0	25.40	23	1.2	4000
1.25	31.8	29.4	1.2	4000
1.5	38.1	35.7	1.2	4000
2.0	50.80	47.8	1.5	4000
2.5	63.50	59.5	2.0	4000
3.0	76.20	72.2	2.0	4000
3.5	88.9	84.9	2.0	4000
4.0	101.6	97.6	2.0	4000

BA管規格 (BA Tube)

Size	D	C	t	L
0.25S	6.35	4.35	1.00	4000
3/8S	9.53	7.53	1.00	4000

配管規格 (Other Tube)

Size	D	C	t	L
5.0S	139.8	133.8	3.0	6000
6.0S	165.2	159.2	3.0	6000
8.0S	216.3	210.3	3.0	6000

## 2S

90° 長焊彎

90° Long Elbow WW

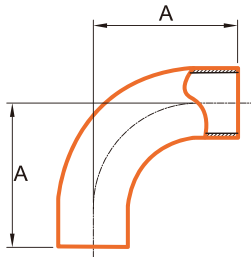

Nominal Size		A		t
inch	mm.	inch	mm.	mm.
1/2	12.70	3.000	76.2	1.65
3/4	19.05	3.000	76.2	1.65
1	25.40	2.063	52.4	1.65
1 1/2	38.10	2.938	74.6	1.65
2	50.80	4.063	103.2	1.65
2 1/2	63.50	5.188	131.8	1.65
3	76.20	6.312	160.3	1.65
4	101.60	8.313	211.2	2.11
6	152.40	12.460	316.5	2.77

## 2WCL

90° 短焊彎

90° Short Elbow WW

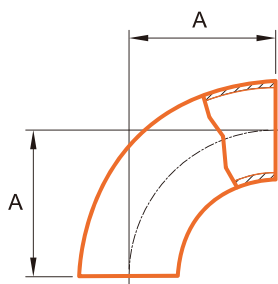

Nominal Size		A		t
inch	mm.	inch	mm.	mm.
1/2	12.70	1.125	28.6	1.65
3/4	19.05	1.125	28.6	1.65
1	25.40	1.500	38.1	1.65
1 1/2	38.10	2.250	57.2	1.65
2	50.80	3.000	76.2	1.65
2 1/2	63.50	3.750	95.3	1.65
3	76.20	4.500	114.3	1.65
4	101.60	6.000	152.4	2.11
6	152.40	9.000	228.6	2.77
8	203.20	12.000	304.8	2.77
10	254.00	15.000	381.0	2.77
12	304.80	18.000	457.2	3.00

# 2KS

45° 長焊彎  
45° Long  
Elbow WW

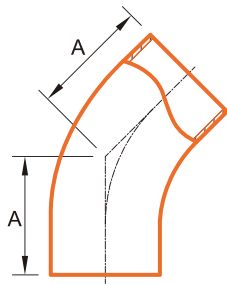

Nominal Size		A		†
inch	mm.	inch	mm.	mm.
1/2	12.70	2.250	57.2	1.65
3/4	19.05	2.250	57.2	1.65
1	25.40	1.188	30.2	1.65
1 1/2	38.10	1.625	41.3	1.65
2	50.80	2.313	58.7	1.65
2 1/2	63.50	3.000	76.2	1.65
3	76.20	3.688	93.7	1.65
4	101.60	4.813	122.3	2.11
6	152.40	6.250	158.8	2.77

# 2WK

45° 短焊彎  
45° Short  
Elbow WW

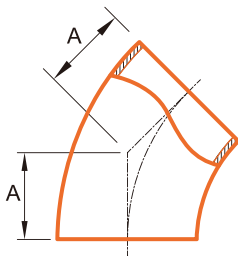

Nominal Size		A		†
inch	mm.	inch	mm.	mm.
1/2	12.70	0.466	11.8	1.65
3/4	19.05	0.466	11.8	1.65
1	25.40	0.625	15.9	1.65
1 1/2	38.10	0.938	23.8	1.65
2	50.80	1.250	31.8	1.65
2 1/2	63.50	1.563	39.7	1.65
3	76.20	1.875	47.6	1.65
4	101.60	2.500	63.5	2.11
6	152.40	3.750	95.3	2.77
8	203.20	5.000	127.0	2.77
10	254.00	6.250	158.8	2.77
12	304.80	7.500	190.5	3.00

# 2CMP

90° 夾式彎頭  
90° Clamp Short  
Elbow CC

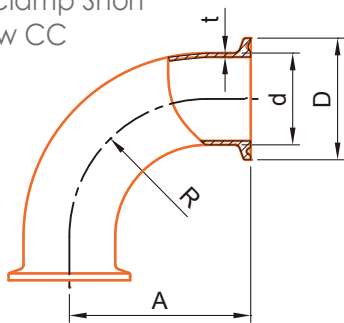

Size	d mm	D mm	A mm	† mm
1/2"	12.7	25.2	41.30	1.65
3/4"	19.05	25.2	41.30	1.65
1.0"	25.4	50.5	50.8	1.65
1.5"	38.1	50.5	69.9	1.65
2.0"	50.8	64	88.9	1.65
2.5"	63.5	77.5	107.9	1.65
3.0"	76.2	91	127.0	1.65
4.0"	101.6	119	168.2	2.11
6.0"	152.4	166.8	250.83	2.77

# 2KMP

45° 夾式彎頭  
45° Clamp Short  
Elbow CC

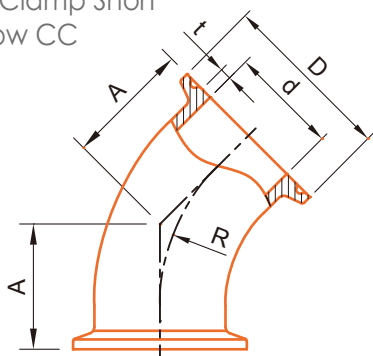

Size	d mm	D mm	A mm	† mm
1/2"	12.7	25.2	24.6	1.65
3/4"	19.05	25.2	24.6	1.65
1.0"	22.1	50.5	28.5	1.65
1.5"	34.8	50.5	36.5	1.65
2.0"	47.5	64	44.45	1.65
2.5"	60.2	77.5	52.3	1.65
3.0"	72.9	91	60.3	1.65
4.0"	97.6	119	79.3	2.11
6.0"	152.4	166.8	117.50	2.77



# SANITARY FITTING 衛生級管件

## 2CMS

單夾90° 短焊彎

90° Clamp X Weld  
Short Elbow CW

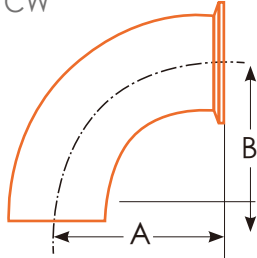

Nominal Size		A		B	
inch	mm	inch	mm	inch	mm
1/2	12.70	1.625	41.30	1.125	28.60
3/4	19.05	1.625	41.30	1.125	28.60
1	25.40	2.000	50.80	1.500	38.10
1 1/2	38.10	2.750	69.90	2.250	57.20
2	50.80	3.500	88.90	3.000	76.20
2 1/2	63.50	4.250	107.95	3.750	95.25
3	76.20	5.000	127.00	4.500	114.30
4	101.60	6.625	168.28	6.000	152.40
6	152.40	9.875	250.80	9.000	228.60

## 7W

長焊三通

Long Equal Tee

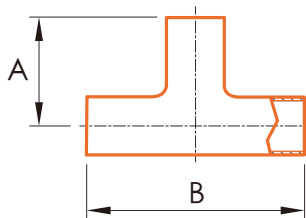

Nominal Size		A		B	
inch	mm.	inch	mm.	inch	mm.
1/2	12.70	1.875	47.6	3.750	95.3
3/4	19.05	2.000	50.8	4.000	101.6
1	25.40	1.875	47.6	3.750	95.3
1 1/2	38.10	2.250	57.2	4.500	114.3
2	50.80	3.000	76.2	6.000	152.4
2 1/2	63.50	3.000	76.2	6.000	152.4
3	76.20	3.250	82.6	6.500	165.1
4	101.60	3.875	98.4	7.750	196.9
6	152.40	5.625	142.9	11.250	285.8
8	203.20	7.000	177.8	14.000	355.6



# 7WWW

短焊三通

Short Equal Tee

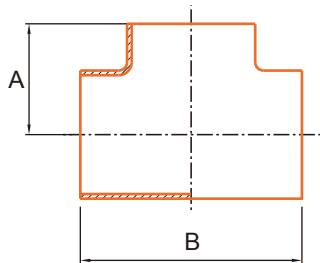

Nominal Size		A		B	
inch	mm.	inch	mm.	inch	mm.
1/2	12.7	1.125	28.6	2.25	57.2
3/4	19.05	1.125	28.6	2.25	57.2
1	25.4	1.125	28.6	2.25	57.2
1 1/2	38.1	1.656	42.1	3.312	84.2
2	50.8	2.062	52.4	4.124	104.8
2 1/2	63.5	2.344	59.5	4.688	119.0
3	76.2	2.594	65.9	5.188	131.8
4	101.6	3.438	87.3	6.876	174.6

# 7RW

異徑長焊三通

Long Reducing Tee

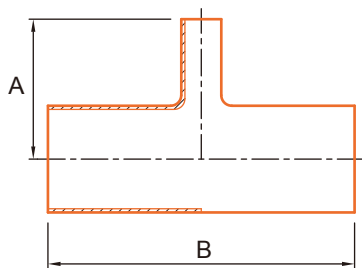

Nominal Size		A		B	
inch	mm.	inch	mm.	inch	mm.
3/4 x 1/2	19.05 x 12.70	2.000	50.8	4.000	101.6
1 x 1/2	25.40 x 12.70	2.125	53.9	4.250	107.9
x 3/4	25.40 x 19.05	2.125	53.9	4.250	107.9
1 1/2 x 1/2	38.10 x 12.70	2.375	60.3	4.750	120.6
x 3/4	38.10 x 19.05	2.375	60.3	4.750	120.6
x 1	38.10 x 25.40	2.125	53.9	4.500	114.3
2 x 1/2	50.80 x 12.70	2.625	66.6	5.750	146.0
x 3/4	50.80 x 19.05	2.625	66.6	5.750	146.0
x 1	50.80 x 25.40	2.375	60.3	6.000	152.4
x 1 1/2	50.80 x 38.10	2.500	63.5	6.000	152.4
2 1/2 x 1 1/2	63.50 x 38.10	2.752	69.9	6.000	152.4
x 2	63.50 x 50.80	3.252	82.6	6.000	152.4
3 x 1	76.20 x 25.40	2.874	73.0	6.500	165.1
x 1 1/2	76.20 x 38.10	3.000	76.2	6.500	165.1
x 2	76.20 x 50.80	3.500	88.9	6.500	165.1
x 2 1/2	76.20 x 63.50	3.252	82.6	6.500	165.1
4 x 1	101.6 x 25.40	3.374	85.7	7.750	196.8
x 1 1/2	101.6 x 38.10	3.500	88.9	7.750	196.8
x 2	101.6 x 50.80	4.000	101.6	7.750	196.8
x 2 1/2	101.6 x 63.50	3.750	95.5	7.750	196.8
x 3	101.6 x 76.20	3.750	95.5	7.750	196.8



# SANITARY FITTING 衛生級管件

## 7RWWW

異徑短焊三通

Short Reducing Tee

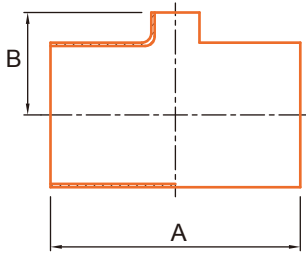

Nominal Size		A		B	
inch	mm.	inch	mm.	inch	mm.
3/4 x 1/2	19.05 x 12.7	3.75	95.2	1.	25.4
1 x 1/2	25.4 x 12.7	3.75	95.2	1.5	38.1
x 3/4	x 19.05	3.75	95.2	2.0	50.8
1 1/2 x 1/2	38.1 x 12.7	4.5	114.3	2.25	57.1
x 3/4	x 19.05	4.5	114.3	2.25	57.1
x 1	x 25.4	3.312	84.1	1.375	34.9
2 x 1/2	50.8 x 12.7	4.124	104.7	1.625	41.2
x 3/4	x 19.05	4.124	104.7	1.625	41.2
x 1	x 25.4	4.124	104.7	1.625	41.2
x 1 1/2	x 38.1	4.124	104.7	1.906	48.4
2 1/2 x 1	63.5 x 25.4	4.688	119.	1.875	47.6
x 1 1/2	x 38.1	4.688	119.	2.156	54.7
x 2	x 50.8	4.688	119.	2.312	58.7
3 x 1	76.2 x 25.4	5.188	131.7	2.126	54.0
x 1 1/2	x 38.1	5.188	131.7	2.406	61.1
x 2	x 50.8	5.188	131.7	2.562	65.
x 2 1/2	x 63.5	5.188	131.7	2.594	65.8
4 x 1	101.6 x 25.4	6.876	174.6	2.626	66.7
x 1 1/2	x 38.1	6.876	174.6	2.906	73.8
x 2	x 50.8	6.876	174.6	3.062	77.7
x 2 1/2	x 63.5	6.876	174.6	3.094	78.5
x 3	x 76.2	6.876	174.6	3.094	78.5

## 7MP

夾式長三通

Clamp Long Equal Tee

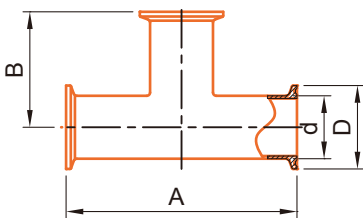

Size	d mm	D mm	B mm	A mm	t mm
1/2"	12.7	25.2	60.33	120.65	1.65
3/4"	19.05	25.2	63.5	127	1.65
1.0"	25.4	50.5	60.3	120.6	1.65
1.5"	38.1	50.5	69.9	139.8	1.65
2.0"	50.8	64	88.9	177.8	1.65
2.5"	63.5	77.5	88.9	177.8	1.65
3.0"	76.2	91	95.3	190.6	1.65
4.0"	101.6	119	114.2	228.4	2.11
6.0"	152.4	166.8	165.1	330.2	2.77

# 7MPS

夾式短三通

Clamp Short Equal Tee

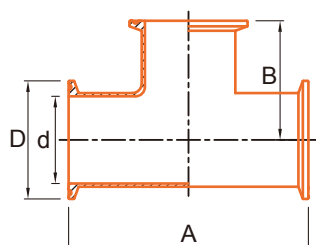

Size	d mm	D mm	B mm	A mm	t mm
1.0"	25.4	50.5	41.2	82	1.65
1.5"	38.1	50.5	55.5	110	1.65
2.0"	50.8	64	64.6	130	1.65
2.5"	63.5	77.5	72.4	145	1.65
3.0"	76.2	91	79.9	159	1.65
4.0"	101.6	119	101.2	210	2.11

# 7RMP

夾式異徑長三通

Clamp Long Reducing Tee

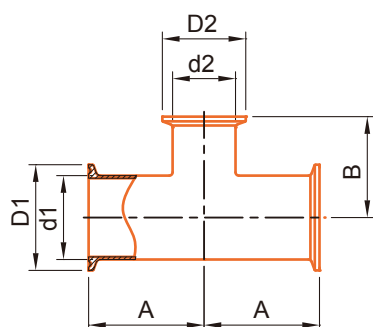

Size inch	d1 mm	D1 mm	d2 mm	D2 mm	A mm	B mm	C mm	D mm
3/4"x1/2"	19.05	25.2	12.7	25.2	63.5	63.5	60.33	38.1
1"x1/2"	25.4	50.5	12.7	25.2	66.68	66.68	60.33	50.8
1"x3/4"	25.4	50.5	19.05	25.2	66.68	66.68	60.33	63.5
1.5"x1/2"	38.1	50.5	12.7	25.2	73.03	73.03		
1.5"x3/4"	38.1	50.5	19.05	25.2	73.03	73.03	69.85	69.85
1.5"x1"	38.1	50.5	25.4	50.5	69.85	66.68	54.76	47.63
2"x1/2"	50.8	64	12.7	25.2	85.73	79.38		
2"x3/4"	50.8	64	19.05	25.2	85.73	79.38		
2"x1"	50.8	64	25.4	50.8	88.9	73	65.08	53.98
2"x1.5"	50.8	64	38.1	50.8	88.9	76.2	65.08	61.11
2.5"x1.5"	63.5	77.5	38.1	50.8	88.9	82.55	72.24	67.46
2.5"x2"	63.5	77.5	50.8	64	88.9	95.25	72.24	71.42
3"x1"	76.2	91	25.4	50.8	95.25	85.7	78.59	66.7
3"x1.5"	76.2	91	38.1	50.8	95.25	88.9	78.59	73.81
3"x2"	76.2	91	50.8	64	95.25	101.6	78.59	77.77
3"x2.5"	76.2	91	63.5	77.5	95.25	95.25	78.59	78.59
4"x1"	101.6	119	25.4	50.8	114.23	98.4	103.13	79.4
4"x1.5"	101.6	119	38.1	50.8	114.23	101.6	103.13	86.51
4"x2"	101.6	119	50.8	64	114.23	114.3	103.13	90.47
4"x2.5"	101.6	119	63.5	77.5	114.23	107.95	103.13	91.29
4"x3"	101.6	119	76.2	91	114.23	107.95	103.13	91.29
6"x1.5"	152.4	166.8	38.1	50.8	165.1	127		
6"x2"	152.4	166.8	50.8	64	165.1	127	149.22	133.35
6"x3"	152.4	166.8	76.2	91	165.1	136.53	149.22	136.53
6"x4"	152.4	166.8	101.6	119	165.1	145.98	149.22	136.45

# 7RMPS

夾式異徑短三通

Clamp Short Reducing Tee

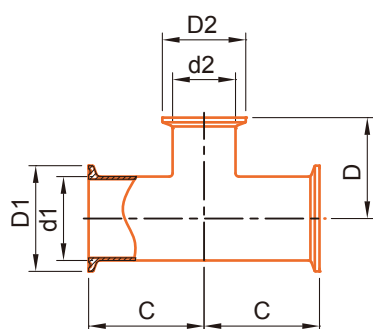



# SANITARY FITTING 衛生級管件

## 7WWM

中間夾式兩邊焊式短三通  
Short Equal Tee WCW

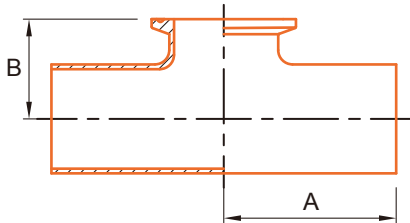

Nominal Size		A	B
Inch	mm	mm	mm
1	25.4	54.00	28.60
1.5	38.10	60.30	34.90
2	50.8	73.00	41.30
2.5	63.50	79.40	47.60
3	76.20	85.70	54.00
4	101.60	104.80	69.90

## 31W

焊式同心大小頭  
Concentric Reducer WW

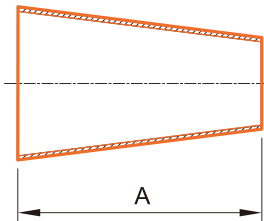

Nominal Size		A	
inch	mm.	inch	mm.
3/4 x 1/2	19.05 x 12.70	1.000	25.4
1 x 1/2	25.40 x 12.70	1.000	25.4
x 3/4	x 19.05	1.000	25.4
1 1/2 x 1/2	38.10 x 12.70	2.500	63.5
x 3/4	x 19.05	2.000	50.8
x 1	x 25.40	2.000	50.8
2 x 1/2	50.80 x 12.70	6.000	152.4
x 3/4	x 19.05	5.000	127.0
x 1	x 25.40	4.000	101.6
x 1 1/2	x 38.10	2.000	50.8
2 1/2 x 1 1/2	63.50 x 38.10	4.000	101.6
x 2	x 50.80	2.000	50.8
3 x 1	76.20 x 25.40	8.000	203.2
x 1 1/2	x 38.10	6.000	152.4
x 2	x 50.80	4.000	101.6
x 2 1/2	x 63.50	2.000	50.8
4 x 1 1/2	101.60 x 38.10	10.000	254.0
x 2	x 50.80	8.000	203.2
x 2 1/2	x 63.50	6.000	152.4
x 3	x 76.20	4.000	101.6
6 x 2	152.40 x 50.80	5.500	139.7
x 3	x 76.20	5.500	139.7
x 4	x 101.60	5.500	139.7
8 x 4	203.20 x 101.60	6.000	152.4
x 6	x 152.40	6.000	152.4

# 32W

焊式偏心大小頭

Eccentric Reducer WW

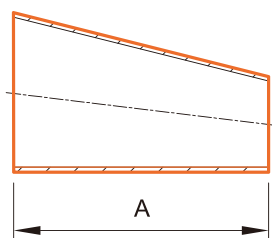

Nominal Size		A	
inch	mm.	inch	mm.
3/4 x 1/2	19.05 x 12.70	1.000	25.4
1 x 1/2	25.40 x 12.70	1.000	25.4
x 3/4	x 19.05	1.000	25.4
1 1/2 x 1/2	38.10 x 12.70	2.500	63.5
x 3/4	x 19.05	2.000	50.8
x 1	x 25.40	2.000	50.8
2 x 1/2	50.80 x 12.70	6.000	152.4
x 3/4	x 19.05	5.000	127.0
x 1	x 25.40	4.000	101.6
x 1 1/2	x 38.10	2.000	50.8
2 1/2 x 1 1/2	63.50 x 38.10	4.000	101.6
x 2	x 50.80	2.000	50.8
3 x 1	76.20 x 25.40	8.000	203.2
x 1 1/2	x 38.10	6.000	152.4
x 2	x 50.80	4.000	101.6
x 2 1/2	x 63.50	2.000	50.8
4 x 1 1/2	101.60 x 38.10	10.000	254.0
x 2	x 50.80	8.000	203.2
x 2 1/2	x 63.50	6.000	152.4
x 3	x 76.20	4.000	101.6
6 x 3	152.40 x 76.20	5.500	139.7
x 4	x 101.60	5.500	139.7
8 x 4	203.20 x 101.60	6.000	152.4
x 6	x 152.40	6.000	152.4

# 31MP

夾式同心大小頭

Concentric Reducer CC

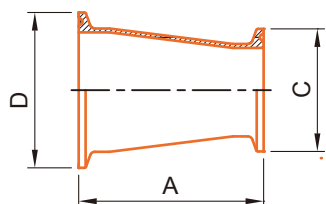

Size	D mm	C mm	A mm
1.5" x 1.0"	50.5	50.5	76.2
2.0" x 1.5"	64	50.5	76.2
2.5" x 1.5"	77.5	50.5	127
2.5" x 2.0"	77.5	64	76.2
3.0" x 1.5"	91	50.5	177.8
3.0" x 2.0"	91	64	127
3.0" x 2.5"	91	77.5	76.2
4.0" x 1.5"	119	50.5	282.5
4.0" x 2.0"	119	64	231.7
4.0" x 2.5"	119	77.5	180.9
4.0" x 3.0"	119	91	130.1



# SANITARY FITTING 衛生級管件

## 32MP

夾式偏心大小頭  
Eccentric Reducer CC

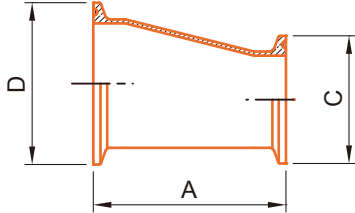

Size	D mm	C mm	A mm
1.5" x 1.0"	50.5	50.5	76.2
2.0" x 1.5"	64	50.5	76.2
2.5" x 1.5"	77.5	50.5	127.0
2.5" x 2.0"	77.5	64	76.2
3.0" x 1.5"	91	50.5	177.8
3.0" x 2.0"	91	64	127.0
3.0" x 2.5"	91	77.5	76.2
4.0" x 1.5"	119	50.5	282.5
4.0" x 2.0"	119	64	231.7
4.0" x 2.5"	119	77.5	180.9
4.0" x 3.0"	119	91	130.1

## 9WWW

焊式短十字通  
Short Equal 4-Way Cross

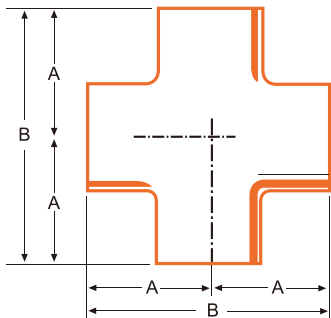

Nominal Size		A		B	
Inch	mm	Inch	mm	Inch	mm
1	25.40	1.125	28.6	2.250	57.2
1 1/2	38.10	1.656	42.1	3.313	84.2
2	50.80	2.063	52.4	4.125	104.8
2 1/2	63.50	2.344	59.5	4.688	119.1
3	76.20	2.594	65.9	5.188	131.8
4	101.60	3.438	87.3	6.875	174.6

## 9MP

夾式長十字通  
Clamp Long Equal  
4-Way Cross

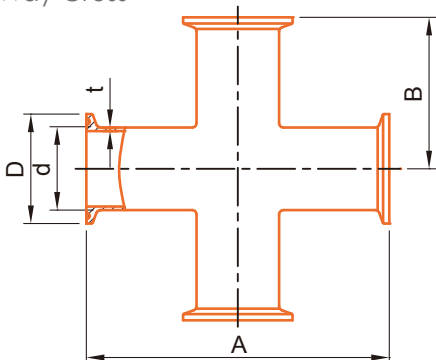

Size	d mm	D mm	A mm	B mm	t mm
1.0"	25.4	50.5	120.6	60.3	1.65
1.5"	38.1	50.5	139.8	69.9	1.65
2.0"	50.8	64	177.8	88.9	1.65
2.5"	63.5	77.5	177.8	88.9	1.65
3.0"	76.2	91	190.6	95.3	1.65
4.0"	101.6	119	228.4	114.2	2.11

# 2WUL

焊式180度彎頭

180° Short U Bend WW

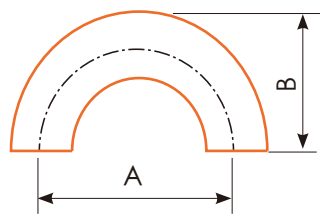

中心距可依需求訂製

Nominal Size		A		B	
Inch	mm	Inch	mm	Inch	mm
1	25.40	3.000	76.20	2.000	50.80
1 1/2	38.10	4.500	114.30	3.000	76.20
2	50.80	6.000	152.40	4.000	101.60
2 1/2	63.50	7.500	190.50	5.000	127.00
3	76.20	9.000	228.60	6.000	152.40
4	101.60	12.000	304.80	8.000	203.20

# 2WUMP

夾式180度彎頭

180° Clamp

U Bend CC

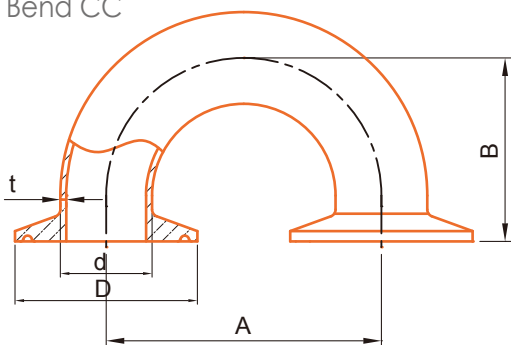

中心距可依需求訂製

Size	d mm	D mm	A mm	B mm	t mm
1.0"	25.4	50.5	76.2	50.8	1.65
1.5"	38.1	50.5	114.3	69.9	1.65
2.0"	50.8	64	152.4	88.9	1.65
2.5"	63.5	77.5	190.5	107.9	1.65
3.0"	76.2	91	228.6	127	1.65
4.0"	101.6	119	304.8	168.2	2.11

# 16W

管帽

Tube Weld Cap

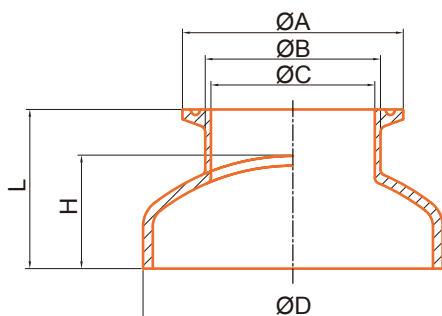

Nominal Size		A	
Inch	mm	Inch	mm
1/2	12.70	0.250	6.4
3/4	19.05	0.312	7.9
1	25.40	0.375	9.5
1 1/2	38.10	0.562	14.3
2	50.80	0.750	19.1
2 1/2	63.50	1.000	25.4
3	76.20	1.250	31.8
4	101.60	1.500	38.1
6	152.40	2.000	50.8
8	203.20	2.500	63.5

Size	ØA mm	ØB mm	ØC mm	ØD mm	H mm	L <sup>+0.5</sup> <sub>-0.5</sub> mm
4"x1.5"	50.5	38.1	34.8	101.6	38.1	57.0
4"x2"	64.0	50.8	47.5	101.6	38.1	57.0



# Ferrule/Blank 夾接頭/盲版

## 16AMP

夾盲板

Solid End Cap

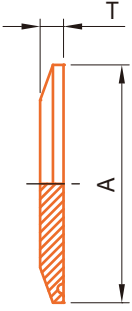

SIZE	A	T
1/2"-3/4"	25.0	4.8
1-1.5"	50.5	6.4
2.0"	64.0	6.4
2.5"	77.5	6.4
3.0"	91.0	6.4
4.0"	119.0	7.9
5.0"	144.5	7.9
6.0"	166.9	11.1
8.0"	217.7	11.1
10"	268.5	11.1
12"	319.3	11.1

## 3A

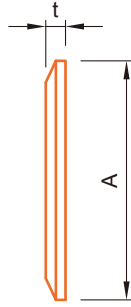

SIZE	A	t
1/2"-3/4"	25.0	4.8
1-1.5"	50.5	6.4
2.0"	64.0	6.4
2.5"	77.5	6.4
3.0"	91.0	6.4
4.0"	119.0	7.9
6.0"	166.9	11.1
8.0"	217.1	11.1
10"	268.5	11.1
12"	319.3	11.1

## ISO

SIZE	A	t
DN20-32	50.5	6.4
DN40	64	6.4
DN50	77.5	6.4
DN65	91	6.4
DN80	106	6.4
DN100	130	7.9
DN125	155	7.9
DN150	183	11.1
DN200	233.5	11.1

## 14WMP

短夾接焊

Short Welding Ferrule

## 14MMP

中夾接焊

Medium Welding Ferrule

## 14AMP

長夾接焊

Long Welding Ferrule

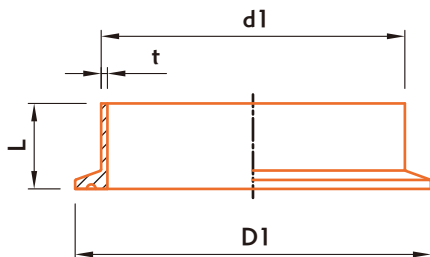

3A Size	D1	d1	t	12101 14WMP	12102 14MMP	12103 14AMP
	mm	mm	mm	L1 mm	L2 mm	L3 mm
1/2"	25.2	12.75	1.65	12.7	21.5	28.6
3/4"	25.2	19.05	1.65	12.7	21.5	28.6
1.0"	50.5	25.4	1.65	12.7	21.5	28.6
1.5"	50.5	38.1	1.65	12.7	21.5	28.6
2.0"	64.0	50.8	1.65	12.7	21.5	28.6
2.5"	77.5	63.5	1.65	12.7	21.5	28.6
3.0"	91.0	76.2	1.65	12.7	21.5	28.6
4.0"	119.0	101.6	2.1	12.7	21.5	28.6

ISO				12108	12107
DN	D1	d1	t	L1	L2
	mm	mm	mm	mm	mm
8	34	13.5	1.6	21.5	28.6
10	34	17.5	1.75	21.5	28.6
15	34	21.6	1.75	21.5	28.6
20	50.5	26.9	1.6	21.5	28.6
25	50.5	33.7	1.6	21.5	28.6
32	50.5	42.4	1.6	21.5	28.6
40	64	48.3	1.6	21.5	28.6
50	77.5	60.3	2	21.5	28.6
65	91	76.1	2	21.5	28.6
80	106	88.9	2	21.5	28.6
100	130	114.3	2.6	21.5	28.6
125	155	139.7	3	/	/
150	183	162.3000	3	/	/
200	233.5	219.1	3	/	/



# FERRULE 夾接頭

## 14RMP

夾接擴

Roll-On Ferrule

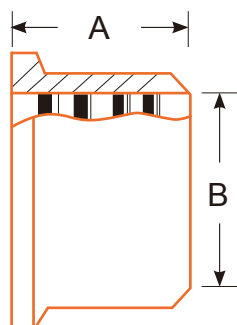

Nominal Size	A	B
Inch	mm	mm
1	19.05	25.53
1 1/2	28.58	38.23
2	33.32	50.93
2 1/2	34.93	63.63
3	36.50	76.33
4	38.10	101.73
6	50.80	152.53

## 14WLMP

加長接環

Light Tank Welding Ferrule

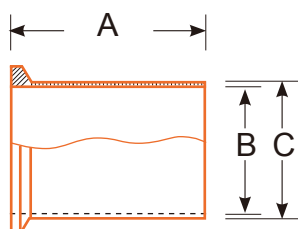

Nominal Size	A	B	C
Inch	mm	mm	mm
1	76.20	22.10	25.40
1 1/2	76.20	34.80	38.10
2	76.20	47.50	50.80
2 1/2	76.20	60.20	63.50
3	101.60	72.90	76.20
4	101.60	97.38	101.60
6	152.40	146.86	152.40
8	152.40	197.10	203.20
10	152.40	248.46	254.00
12	152.40	298.70	304.80



# FERRULE ADAPTER 夾接轉接頭

## 14MPHR

夾式膠管接頭  
Rubber Hose Adapter

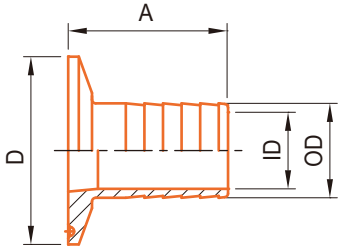

Size	ØA	ØB	ØC	L
1/2" x 1/2"	25.4	12.7	9.4	38.1
3/4" x 3/4"	25.4	19.05	15.7	38.1
1" x 1/2"	50.5	12.7	9.4	38.1
1" x 3/4"	50.5	19.05	15.7	38.1
1" x 1"	50.5	25.4	22.2	42.9
1.5" x 1-1/4"	50.5	31.8	28.5	42.9
1.5" x 1.5"	50.5	38.1	34.8	42.9
2" x 2"	64.0	50.8	47.5	58.7
2.5" x 2.5"	77.5	63.5	60.2	59.5
3" x 3"	91.0	76.2	72.9	78.6
4" x 4"	119.0	101.6	97.4	86.5

## 21MP

夾配外牙  
Male X Clamp Adapter

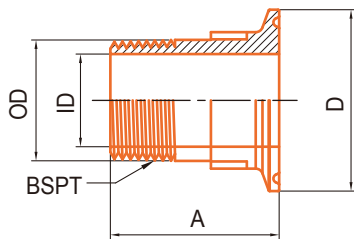

Size	D	ID	OD	A	PT
1/2" x 1/2"	25.2	9.8	21.5	41.0	1/2"
3/4" x 3/4"	25.2	15.9	27	41.0	3/4"
1" x 1/2"	50.5	15.8	21.5	43.0	1/2"
1" x 3/4"	50.5	20.8	27.5	43.0	3/4"
1" x 1"	50.5	25.8	33.7	47.0	1"
1.5" x 1.2"	50.5	29.5	42.2	50.0	1.2"
1.5" x 1.5"	50.5	34.8	48.5	50.0	1.5"

## 22MP

夾配內牙  
Female X Clamp Adapter

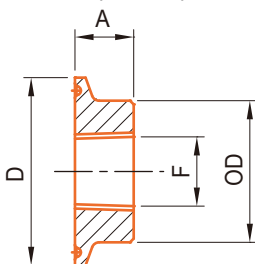

Size	ØA	ØB	ØC	H	L	PT
1.5" x 1/4"	50.5	43.5	40.6	19.2	31.6	1/4" x 19T
1.5" x 3/8"	50.5	43.5	40.6	19.2	34.0	3/8" x 19T
1.5" x 1/2"	50.5	43.5	40.6	19.2	34.0	1/2" x 14T
1.5" x 3/4"	50.5	43.5	40.6	19.2	32.0	3/4" x 14T
1.5" x 1"	50.5	43.5	42.0	19.2	37.0	1" x 11T

# FERRULE GASKET 夾接環密封圈

Temperature range:

- 10° to +95°C (EPDM)
- 10° to +225°C (Silicon)
- 10° to +200°C (Viton)
- 20° to +120°C (PTFE)

1/2" & 3/4"

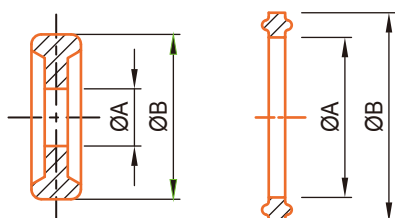

## Plain Type 13PG 無端夾膠墊

### 3A

SIZE	ØA	ØB
1/2"	9.9	21.8
3/4"	16.3	21.8
A37	15.5	33
1"	22.7	50
1.5"	35.9	50
2"	48.6	63.5
2.5"	61.3	76.2
3"	74	88.9
4"	98.6	118
6"	147.8	165
8"	196.6	216

### ISO

SIZE	ØA	ØB
DN8	11.1	33.2
DN12	14.8	33.2
DN15	18.9	33.2
DN20	24.5	49.7
DN25	31.3	49.7
DN32	40	49.7
DN40	45.9	63.2
DN50	57.1	76.7
DN65	72.9	90.2
DN80	85.7	105.2
DN100	109.9	129.2
DN125	134.5	154.2
DN150	163.1	182.2
DN200	211.9	232.7

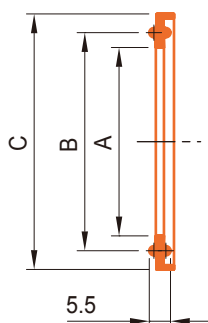

## Flange Type 13FG 有端夾膠墊

Size	A	B	C
1"	22.8	43.5	52.7
1.5"	35.8	43.5	52.7
2"	48.8	56.5	66.2
2.5"	60.5	70.5	79.7
3"	73.1	83.5	93.2
4"	97.8	110.0	121.2
6"	148	156.4	169.1
10"	249	258	270.7
12"	300	308.8	321.5



# CLAMP 管束

Materials: 304

## 13MHH

Heavy Duty Single Pin Clamp

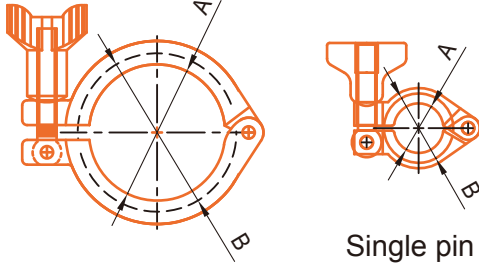

Single pin

Size	A	B
1/2" - 3/4"	20	28
A37	27.8	37
1.5"	44.4	53.6
2.0"	57.8	67
2.5"	71.4	80.6
3.0"	84	94.2
4.0"	110	122.2
6.0"	155.4	170.4
8.0"	205	220
10"	258	272.7
12"	310	323.5

## 13MHHM

Heavy Duty Double Pin Clamp

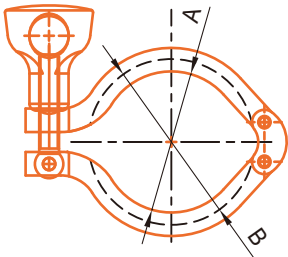

Size	A	B
1.5"	43.6	53.6
2.0"	57	67
2.5"	70.6	80.6
3.0"	84	94
4.0"	112	122
6.0"	155	170
8.0"	205	220.8

## 13SF

Heavy Duty Double Pin Clamp

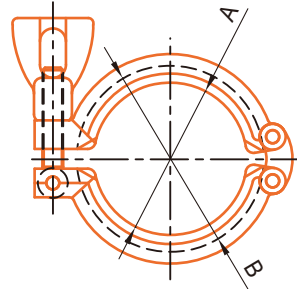

Size	A	B
1.5"	45	58.6
2.0"	59	72
2.5"	67	84
3.0"	85	98
4.0"	114	127

## 13MHP

High Pressure Clamp

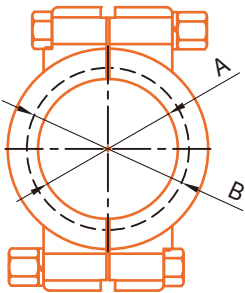

Size	A	B
1/2"-3/4"	20	28
1.5"	43.3	52
2.0"	56.4	65.5
2.5"	69.5	79
3.0"	77.5	92.5
4.0"	109	120.5
6.0"	158	170
8.0"	222.5	237.5

## 13MHHS

3 PIECE CLAMP

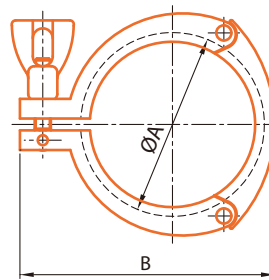

Size	ØA	B
1"~1.5"	54	80
2"	67.5	94
2.5"	80.9	109
3"	94	126
4"	122.4	154
12"	323.4	369

## Wing Nut

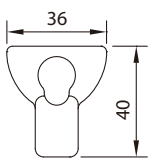

13MHH-8

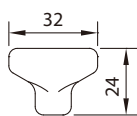

13MHH-10

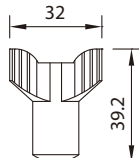

13MHH-11

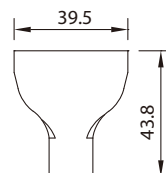

13MHH-12

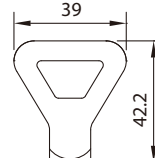

13MHH-13

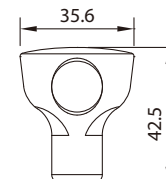

13MHH-14

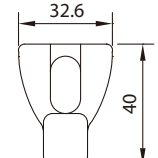

13SP-2

# TUBE HANGER 管固定夾

## TH-A

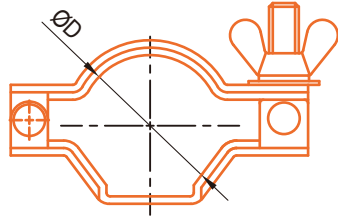

Size	ØD
1.0"	25.4
1.5"	38.1
2.0"	50.8
2.5"	63.5
3.0"	76.2
4.0"	101.6

## TH-B

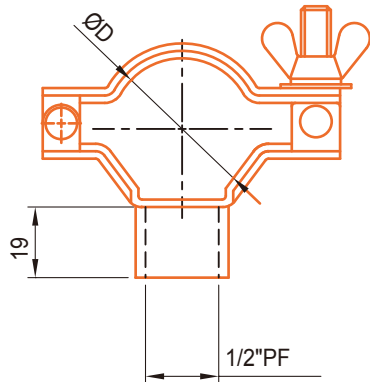

Size	ØD
1.0"	25.4
1.5"	38.1
2.0"	50.8
2.5"	63.5
3.0"	76.2
4.0"	101.6

## TH-C

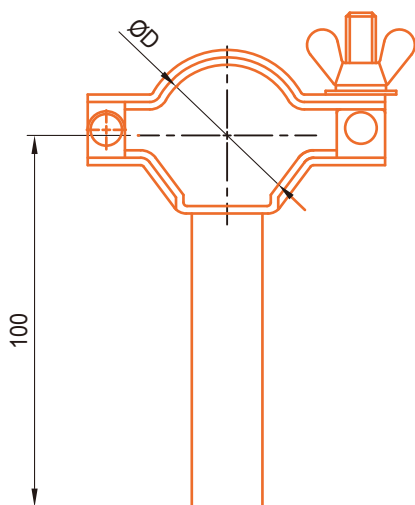

Size	ØD
1.0"	25.4
1.5"	38.1
2.0"	50.8
2.5"	63.5
3.0"	76.2
4.0"	101.6



# BPE FITTING 生技醫藥級管件

All Fittings Comply with  
ASME BPE Table DT-3-1

Final Tolerances for Mechanically Polished Fittings and Process Components

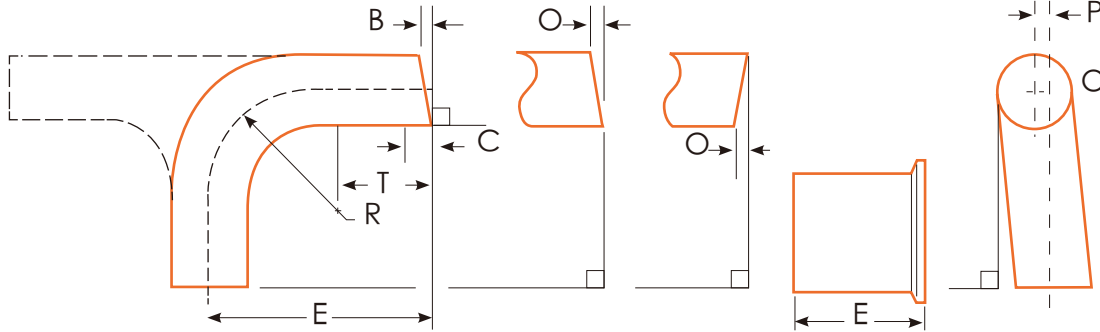

Nominal Size, in.	O.D.		Wall Thickness		Squarness Face to Tangent, B		Off Angel, O		Equivalent Angel (for O) deg	Off Plane, P		Centerline Radius (CLR), R	
	in.	mm	in.	mm	in.	mm	in.	mm		in.	mm	in.	mm
1/4	±0.005	±0.13	+0.003/-0.004	+0.08/-0.10	0.005	0.13	0.009	0.23	2.1	0.030	0.76	0.563	14.3
3/8	±0.005	±0.13	+0.003/-0.004	+0.08/-0.10	0.005	0.13	0.012	0.30	1.8	0.030	0.76	1.125	28.58
1/2	±0.005	±0.13	+0.005/-0.008	+0.13/-0.20	0.005	0.13	0.014	0.36	1.6	0.030	0.76	1.125	28.58
3/4	±0.005	±0.13	+0.005/-0.008	+0.13/-0.20	0.005	0.13	0.018	0.46	1.4	0.030	0.76	1.125	28.58
1	±0.005	±0.13	+0.005/-0.008	+0.13/-0.20	0.008	0.20	0.025	0.64	1.4	0.030	0.76	1.5	38.1
1 1/2	±0.008	±0.20	+0.005/-0.008	+0.13/-0.20	0.008	0.20	0.034	0.86	1.3	0.050	1.27	2.25	57.1
2	±0.008	±0.20	+0.005/-0.008	+0.13/-0.20	0.008	0.20	0.043	1.09	1.2	0.050	1.27	3.000	76.2
2 1/2	±0.010	±0.25	+0.005/-0.008	+0.13/-0.20	0.010	0.25	0.054	1.37	1.2	0.050	1.27	3.750	95.25
3	±0.010	±0.25	+0.005/-0.008	+0.13/-0.20	0.016	0.41	0.068	1.73	1.3	0.050	1.27	4.500	114.30
4	±0.015	±0.38	+0.008/-0.010	+0.20/-0.25	0.016	0.41	0.086	2.18	1.2	0.060	1.52	6.000	152.40
6	±0.030	±0.76	+0.015/-0.015	+0.38/-0.38	0.030	0.76	0.135	3.43	1.3	0.060	1.52	9.000	228.60

## General Notes:

- (a) Tolerance on end-to-end and center-to-end dimension E is  $\pm 0.050''$  (1.27 mm)
- (b) Tolerance for centerline radius (CLR) is  $\pm 10\%$  of the nominal dimension
- (c) The length of the control portion C is fixed for all sizes at 0.75" (19 mm)

## Weld End Chemical Compositions (wt. %)

	C	Si	Mn	P	S	Ni	Cr	Mo
Min.	-	-	-	-	0.005	10.000	16.000	2.000
Max.	0.035	1.000	2.000	0.045	0.017	14.000	18.000	3.000

## BPE Process Contact Surface Finish Requirements Table SF-2.4-1

Surface Designation	Mechanically Polished Ra Max.	
	μin.	μm
SF0	No finish requirement	No finish requirement
SF1	20	0.51
SF2	25	0.64
SF3	30	0.76
Surface Designation	Electropolished Ra Max.	
	μin.	μm
SF4	15	0.38
SF5	20	0.51
SF6	25	0.64

## Acceptance Criteria for Metallic Process Contact Surface Finishes Table SF-2.2-1

Anomaly or Indication	Acceptance Criteria
Pits	If diameter <0.020". (0.51 mm) and bottom is shiny [Notes (1) and (2)]. Pits <0.003" (0.08 mm) diameter is irrelevant and acceptable.
Cluster of pits	No more than 4 pits per each ½" x ½" (13 mm x 13 mm) inspection window. The cumulative total diameter of all relevant pits shall not exceed 0.040" (1.02 mm).
Dents	None accepted [Note (3)].
Finishing marks	If Ra max. is met.
Welds	Welds used in the as-welded condition shall meet the requirements of MJ-8. Welds finished afterwelding shall be flush with the base metal, and concavity and convexity shall meet the requirements of MJ-8. Such finishing shall meet the Ra requirements of Table SF-2.4-1.
Nicks	None accepted.
Scratches	For tubing, if cumulative length is <12.0" (305 mm) per 20' (6.1 m) tube length or prorated and if depth is <0.003" (0.08 mm). For fittings, valves and other process components, if cumulative length is <0.25" (6.4 mm), depth <0.003" (0.08 mm), and Ra max. is met. For vessels, if length <0.50" (13 mm) at 0.003" (0.08 mm) depth and if <3 per inspection window [Note (4)].
Surface cracks	None accepted.
Surface inclusions	If Ra max. is met.
Surface residuals	None accepted, visual inspection.
Surface roughness (Ra)	See Table SF-2.4-1.
Weld slag	For tubing, up to 3 per 20' (6.1 m) length or prorated, if <75% of the width of the weld bead. For fittings, valves, vessels, and other process components, none accepted (as welded shall meet the requirements of MJ-8 and Table MJ-8.4-1).
Porosity	None open to the surface.
Buffing	None accepted.

### General Notes :

- (1) Black bottom pit of any depth is not acceptable.
- (2) Pits in super-austenitic and nickel alloys may exceed this value. Acceptance criteria for pit size shall be established by agreement between owner/user and supplier. All other pit criteria remain the same.
- (3) For vessels, dents in the area covered by and resulting from welding dimple heat transfer jackets are acceptable.
- (4) An inspection window is defined as an area 4" x 4" (100 mm x 100 mm).

## Additional Acceptance Criteria for Electropolished Metallic Process Contact Surface Finishes Table SF-2.2-2

Anomaly or Indication	Acceptance Criteria
Blistering	None accepted
Buffering	None accepted
Cloudiness	None accepted
End grain effect	Acceptable if Ra max. is met
Fixture marks	Acceptable if electropolished
Haze	None accepted
Orange peel	Acceptable if Ra max. is met
Stringer indication	Acceptable if Ra max. is met
Weld whitening	Acceptable if Ra max. is met
Variance in luster	Acceptable if Ra max. is met

### Reference

- American Society of Mechanical Engineers, 2014. 'ASME BPE-2014 Bioprocessing Equipment', Part DT Dimensions and Tolerances for Process Components: 96
- ASTM International, 2015. 'A270/A270M-15', Table 1 Chemical Requirements: 3
- American Society of Mechanical Engineers, 2014. 'ASME BPE-2014 Bioprocessing Equipment', Part SF Process Contact Surface Finishes: 141, 142



# BPE FITTING 生技醫藥級管件

## DT-7

DT-4.1.1-1

90° Elbow WW

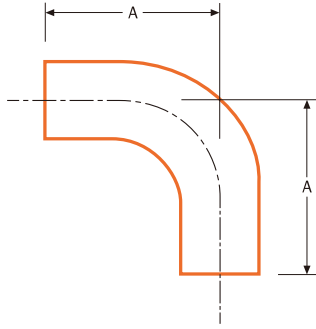

Nominal Size		A	
Inch	mm	Inch	mm
1/4	6.35	2.625	66.70
3/8	9.53	2.625	66.70
1/2	12.70	3.000	76.20
3/4	19.05	3.000	76.20
1	25.40	3.000	76.20
1 1/2	38.10	3.750	95.30
2	50.80	4.750	120.70
2 1/2	63.50	5.500	139.70
3	76.20	6.250	158.80
4	101.60	8.000	203.20
6	152.40	11.500	292.10

## DT-8

DT-4.1.1-4

45° Elbow WW

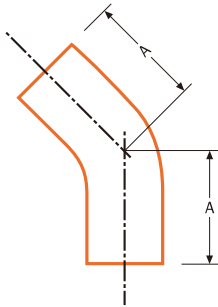

Nominal Size		A	
Inch	mm	Inch	mm
1/4	6.35	2.000	50.80
3/8	9.53	2.000	50.80
1/2	12.70	2.250	57.20
3/4	19.05	2.250	57.20
1	25.40	2.250	57.20
1 1/2	38.10	2.500	63.50
2	50.80	3.000	76.20
2 1/2	63.50	3.375	85.70
3	76.20	3.625	92.10
4	101.60	4.500	114.30
6	152.40	6.250	158.80

## DT-9 & DT-9C

DT-4.1.2-1

Equal Tee WWW

Equal Cross WWWW

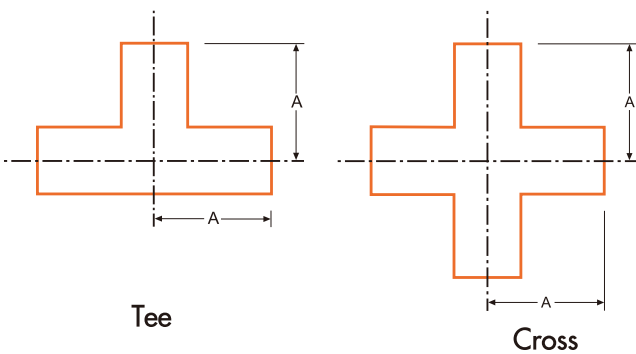

Nominal Size		A	
Inch	mm	Inch	mm
1/4	6.35	1.750	44.50
3/8	9.53	1.750	44.50
1/2	12.70	1.875	47.60
3/4	19.05	2.000	50.80
1	25.40	2.125	54.00
1 1/2	38.10	2.375	60.30
2	50.80	2.875	73.00
2 1/2	63.50	3.125	79.40
3	76.20	3.375	85.70
4	101.60	4.125	104.80
6	152.40	5.625	142.90



# DT-10

## DT-4.1.2-6

Reducing Tee WWW

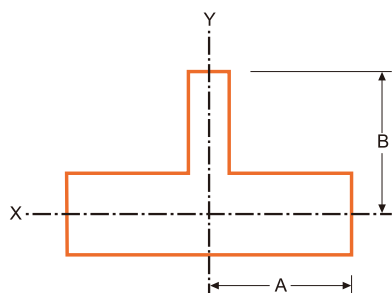

Nominal Size		A		B	
Inch	mm	Inch	mm	Inch	mm
3/8 x 1/4	9.53 x 6.35	1.750	44.50	1.750	44.50
1/2 x 1/4	12.70 x 6.35	1.875	47.60	1.875	47.60
1/2 x 3/8	12.70 x 9.53	1.875	47.60	1.875	47.60
3/4 x 1/4	19.05 x 6.35	2.000	50.80	2.000	50.80
3/4 x 3/8	19.05 x 9.53	2.000	50.80	2.000	50.80
3/4 x 1/2	19.05 x 12.70	2.000	50.80	2.000	50.80
1 x 1/4	25.40 x 6.35	2.125	54.00	2.125	54.00
1 x 3/8	25.40 x 9.53	2.125	54.00	2.125	54.00
1 x 1/2	25.40 x 12.70	2.125	54.00	2.125	54.00
1 x 3/4	25.40 x 19.05	2.125	54.00	2.125	54.00
1 1/2 x 1/2	38.10 x 12.70	2.375	60.30	2.375	60.30
1 1/2 x 3/4	38.10 x 19.05	2.375	60.30	2.375	60.30
1 1/2 x 1	38.10 x 25.40	2.375	60.30	2.375	60.30
2 x 1/2	50.80 x 12.70	2.875	73.00	2.625	66.70
2 x 3/4	50.80 x 19.05	2.875	73.00	2.625	66.70
2 x 1	50.80 x 25.40	2.875	73.00	2.625	66.70
2 x 1 1/2	50.80 x 38.10	2.875	73.00	2.625	66.70
2 1/2 x 1/2	63.50 x 12.70	3.125	79.40	2.875	73.00
2 1/2 x 3/4	63.50 x 19.05	3.125	79.40	2.875	73.00
2 1/2 x 1	63.50 x 25.40	3.125	79.40	2.875	73.00
2 1/2 x 1 1/2	63.50 x 38.10	3.125	79.40	2.875	73.00
2 1/2 x 2	63.50 x 50.80	3.125	79.40	2.875	73.00
3 x 1/2	76.20 x 12.70	3.375	85.70	3.125	79.40
3 x 3/4	76.20 x 19.05	3.375	85.70	3.125	79.40
3 x 1	76.20 x 25.40	3.375	85.70	3.125	79.40
3 x 1 1/2	76.20 x 38.10	3.375	85.70	3.125	79.40
3 x 2	76.20 x 50.80	3.375	85.70	3.125	79.40
3 x 2 1/2	76.20 x 63.50	3.375	85.70	3.125	79.40
4 x 1/2	101.60 x 12.70	4.125	104.80	3.625	92.10
4 x 3/4	101.60 x 19.05	4.125	104.80	3.625	92.10
4 x 1	101.60 x 25.40	4.125	104.80	3.625	92.10
4 x 1 1/2	101.60 x 38.10	4.125	104.80	3.625	92.10
4 x 2	101.60 x 50.80	4.125	104.80	3.875	98.40
4 x 2 1/2	101.60 x 63.50	4.125	104.80	3.875	98.40
4 x 3	101.60 x 76.20	4.125	104.80	3.875	98.40
6 x 3	152.40 x 76.20	5.625	142.90	4.875	123.80
6 x 4	152.40 x 101.60	5.625	142.90	5.125	130.20



## DT-11C(a)

Concentric Reducer WW

## DT-11E(a)

Eccentric Reducer WW

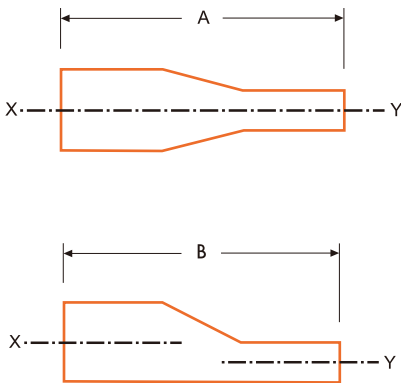

Nominal Size		CR A		ER B	
Inch	mm	Inch	mm	Inch	mm
3/8 x 1/4	9.53 x 6.35	3.250	82.60	4.000	101.60
1/2 x 1/4	12.70 x 6.35	3.250	82.60	4.000	101.60
1/2 x 3/8	12.70 x 9.53	3.250	82.60	4.000	101.60
3/4 x 1/4	19.05 x 6.35	3.250	82.60	4.000	101.60
3/4 x 3/8	19.05 x 9.53	3.250	82.60	4.000	101.60
3/4 x 1/2	19.05 x 12.70	4.000	101.60	4.000	101.60
1 x 1/4	25.40 x 6.35	4.500	114.30	4.500	114.30
1 x 3/8	25.40 x 9.53	4.500	114.30	4.500	114.30
1 x 1/2	25.40 x 12.70	4.500	114.30	4.500	114.30
1 x 3/4	25.40 x 19.05	4.000	101.60	4.000	101.60
1 1/2 x 1/2	38.10 x 12.70	5.500	139.70	5.500	139.70
1 1/2 x 3/4	38.10 x 19.05	5.000	127.00	5.000	127.00
1 1/2 x 1	38.10 x 25.40	5.000	127.00	5.000	127.00
2 x 1/2	50.80 x 12.70	7.750	196.90	7.750	196.90
2 x 3/4	50.80 x 19.05	7.250	184.20	7.250	184.20
2 x 1	50.80 x 25.40	7.250	184.20	7.250	184.20
2 x 1 1/2	50.80 x 38.10	5.250	133.40	5.250	133.40
2 1/2 x 1/2	63.50 x 12.70	9.750	247.70	9.750	247.70
2 1/2 x 3/4	63.50 x 19.05	9.250	235.00	9.250	235.00
2 1/2 x 1	63.50 x 25.40	9.250	235.00	9.250	235.00
2 1/2 x 1 1/2	63.50 x 38.10	7.250	184.20	7.250	184.20
2 1/2 x 2	63.50 x 50.80	5.500	139.70	5.500	139.70
3 x 1	76.20 x 25.40	11.250	285.80	11.250	285.80
3 x 1 1/2	76.20 x 38.10	9.250	235.00	9.250	235.00
3 x 2	76.20 x 50.80	7.500	190.50	7.500	190.50
3 x 2 1/2	76.20 x 63.50	5.500	139.70	5.500	139.70
4 x 1	101.60 x 25.40	15.500	393.70	15.500	393.70
4 x 1 1/2	101.60 x 38.10	13.500	342.90	13.500	342.90
4 x 2	101.60 x 50.80	11.750	298.50	11.750	298.50
4 x 2 1/2	101.60 x 63.50	9.750	247.70	9.750	247.70
4 x 3	101.60 x 76.20	7.750	196.90	7.750	196.90
6 x 3	152.40 x 76.20	10.000	254.00	9.750	247.70
6 x 4	152.40 x 101.60	10.000	254.00	10.000	254.00

# DT-12

DT-4.1.1-2  
90° Elbow CW

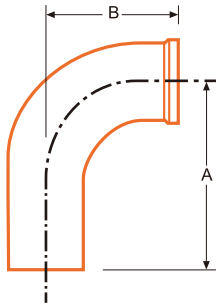

Nominal Size		A		B	
Inch	mm	Inch	mm	Inch	mm
1/4	6.35	2.625	66.70	1.625	41.30
3/8	9.53	2.625	66.70	1.625	41.30
1/2	12.70	3.000	76.20	1.625	41.30
3/4	19.05	3.000	76.20	1.625	41.30
1	25.40	3.000	76.20	2.000	50.80
1 1/2	38.10	3.750	95.30	2.750	69.90
2	50.80	4.750	120.70	3.500	88.90
2 1/2	63.50	5.500	139.70	4.250	108.00
3	76.20	6.250	158.80	5.000	127.00
4	101.60	8.000	203.20	6.625	168.20
6	152.40	11.500	292.10	10.500	266.70

# DT-13

DT-4.1.1-5  
45° Elbow CW

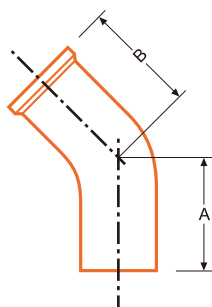

Nominal Size		A		B	
Inch	mm	Inch	mm	Inch	mm
1/4	6.35	2.000	50.80	1.000	25.40
3/8	9.53	2.000	50.80	1.000	25.40
1/2	12.70	2.250	57.20	1.000	25.40
3/4	19.05	2.250	57.20	1.000	25.40
1	25.40	2.250	57.20	1.125	28.60
1 1/2	38.10	2.500	63.50	1.438	36.50
2	50.80	3.000	76.20	1.750	44.50
2 1/2	63.50	3.375	85.70	2.063	52.40
3	76.20	3.625	92.10	2.375	60.30
4	101.60	4.500	114.30	3.125	79.40
6	152.40	6.250	158.80	5.250	133.40



# BPE FITTING 生技醫藥級管件

## DT-14

DT-4.1.2-7

Short Outlet Reducing Tee WCW

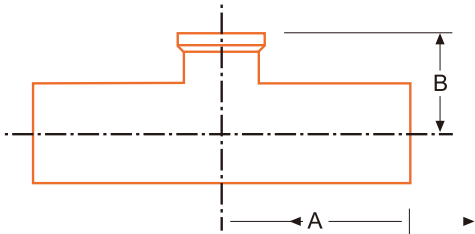

Nominal Size		A		B	
Inch	mm	Inch	mm	Inch	mm
3/8 x 1/4	9.53 x 6.35	1.750	44.50	1.000	25.40
1/2 x 1/4	12.70 x 6.35	1.875	47.60	1.000	25.40
1/2 x 3/8	12.70 x 9.53	1.875	47.60	1.000	25.40
3/4 x 1/4	19.05 x 6.35	2.000	50.80	1.000	25.40
3/4 x 3/8	19.05 x 9.53	2.000	50.80	1.000	25.40
3/4 x 1/2	19.05 x 12.70	2.000	50.80	1.000	25.40
1 x 1/4	25.40 x 6.35	2.125	54.00	1.125	28.60
1 x 3/8	25.40 x 9.53	2.125	54.00	1.125	28.60
1 x 1/2	25.40 x 12.70	2.125	54.00	1.125	28.60
1 x 3/4	25.40 x 19.05	2.125	54.00	1.125	28.60
1 1/2 x 1/2	38.10 x 12.70	2.375	60.30	1.375	34.90
1 1/2 x 3/4	38.10 x 19.05	2.375	60.30	1.375	34.90
1 1/2 x 1	38.10 x 25.40	2.375	60.30	1.375	34.90
2 x 1/2	50.80 x 12.70	2.875	73.00	1.625	41.30
2 x 3/4	50.80 x 19.05	2.875	73.00	1.625	41.30
2 x 1	50.80 x 25.40	2.875	73.00	1.625	41.30
2 x 1 1/2	50.80 x 38.10	2.875	73.00	1.625	41.30
2 1/2 x 1/2	63.50 x 12.70	3.125	79.40	1.875	47.60
2 1/2 x 3/4	63.50 x 19.05	3.125	79.40	1.875	47.60
2 1/2 x 1	63.50 x 25.40	3.125	79.40	1.875	47.60
2 1/2 x 1 1/2	63.50 x 38.10	3.125	79.40	1.875	47.60
2 1/2 x 2	63.50 x 50.80	3.125	79.40	1.875	47.60
3 x 1/2	76.20 x 12.70	3.375	85.70	2.125	54.00
3 x 3/4	76.20 x 19.05	3.375	85.70	2.125	54.00
3 x 1	76.20 x 25.40	3.375	85.70	2.125	54.00
3 x 1 1/2	76.20 x 38.10	3.375	85.70	2.125	54.00
3 x 2	76.20 x 50.80	3.375	85.70	2.125	54.00
3 x 2 1/2	76.20 x 63.50	3.375	85.70	2.125	54.00
4 x 1/2	101.60 x 12.70	4.125	104.80	2.625	66.70
4 x 3/4	101.60 x 19.05	4.125	104.80	2.625	66.70
4 x 1	101.60 x 25.40	4.125	104.80	2.625	66.70
4 x 1 1/2	101.60 x 38.10	4.125	104.80	2.625	66.70
4 x 2	101.60 x 50.80	4.125	104.80	2.625	66.70
4 x 2 1/2	101.60 x 63.50	4.125	104.80	2.625	66.70
4 x 3	101.60 x 76.20	4.125	104.80	2.625	66.70
6 x 1/2	152.40 x 12.70	5.625	142.90	3.625	92.10
6 x 3/4	152.40 x 19.05	5.625	142.90	3.625	92.10
6 x 1	152.40 x 25.40	5.625	142.90	3.625	92.10
6 x 1 1/2	152.40 x 38.10	5.625	142.90	3.625	92.10
6 x 2	152.40 x 50.80	5.625	142.90	3.625	92.10
6 x 2 1/2	152.40 x 63.50	5.625	142.90	3.625	92.10
6 x 3	152.40 x 76.20	5.625	142.90	3.625	92.10
6 x 4	152.40 x 101.60	5.625	142.90	3.750	95.30

## DT-15

DT-4.1.2-2

Short Outlet Equal Tee WCW

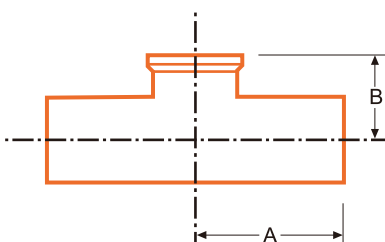

Nominal Size		A		B	
Inch	mm	Inch	mm	Inch	mm
1/4	6.35	1.750	44.50	1.000	25.40
3/8	9.53	1.750	44.50	1.000	25.40
1/2	12.70	1.875	47.60	1.000	25.40
3/4	19.05	2.000	50.80	1.125	28.60
1	25.40	2.125	54.00	1.125	28.60
1 1/2	38.10	2.375	60.30	1.375	34.90
2	50.80	2.875	73.00	1.625	41.30
2 1/2	63.50	3.125	79.40	1.875	47.60
3	76.20	3.375	85.70	2.125	54.00
4	101.60	4.125	104.80	2.750	69.90
6	152.40	5.625	142.90	4.625	117.50

# DT-16

DT-4.1.1-3

90° Clamp Elbow CC

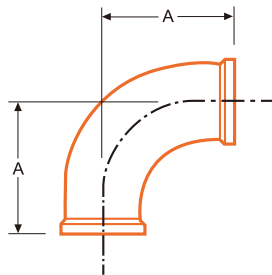

Nominal Size		A	
Inch	mm	Inch	mm
1/4	6.35	1.625	41.30
3/8	9.53	1.625	41.30
1/2	12.70	1.625	41.30
3/4	19.05	1.625	41.30
1	25.40	2.000	50.80
1 1/2	38.10	2.750	69.90
2	50.80	3.500	88.90
2 1/2	63.50	4.250	108.00
3	76.20	5.000	127.00
4	101.60	6.625	168.30
6	152.40	10.500	266.70

# DT-17

DT-4.1.1-6

45° Clamp Elbow CC

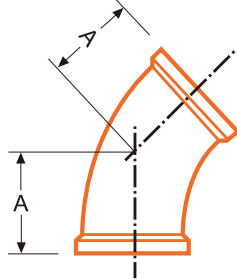

Nominal Size		A	
Inch	mm	Inch	mm
1/4	6.35	1.000	25.40
3/8	9.53	1.000	25.40
1/2	12.70	1.000	25.40
3/4	19.05	1.000	25.40
1	25.40	1.125	28.60
1 1/2	38.10	1.438	36.50
2	50.80	1.750	44.50
2 1/2	63.50	2.063	52.40
3	76.20	2.375	60.30
4	101.60	3.125	79.40
6	152.40	5.250	133.40

# DT-18

DT-4.1.2-4

Clamp Equal Tee CCC

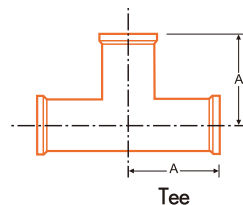

# DT-18C

DT-4.1.2-4

Clamp Equal Cross CCCC

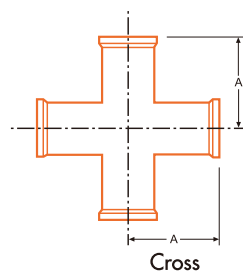

Nominal Size		A	
Inch	mm	Inch	mm
1/4	6.35	2.250	57.20
3/8	9.53	2.250	57.20
1/2	12.70	2.250	57.20
3/4	19.05	2.375	60.30
1	25.40	2.625	66.70
1 1/2	38.10	2.875	73.00
2	50.80	3.375	85.70
2 1/2	63.50	3.625	92.10
3	76.20	3.875	98.40
4	101.60	4.750	120.70
6	152.40	7.125	181.00



## DT-19

### DT-4.1.2-8

Clamp Reducing Tee CCC

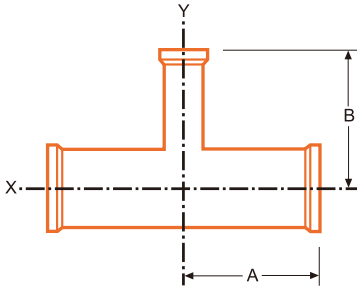

Nominal Size		A		B	
Inch	mm	Inch	mm	Inch	mm
3/8 x 1/4	9.53 x 6.35	2.250	57.20	2.250	57.20
1/2 x 1/4	12.70 x 6.35	2.375	60.30	2.375	60.30
1/2 x 3/8	12.70 x 9.53	2.375	60.30	2.375	60.30
3/4 x 1/4	19.05 x 6.35	2.500	63.50	2.500	63.50
3/4 x 3/8	19.05 x 9.53	2.500	63.50	2.500	63.50
3/4 x 1/2	19.05 x 12.70	2.500	63.50	2.500	63.50
1 x 1/4	25.40 x 6.35	2.625	66.70	2.625	66.70
1 x 3/8	25.40 x 9.53	2.625	66.70	2.625	66.70
1 x 1/2	25.40 x 12.70	2.625	66.70	2.625	66.70
1 x 3/4	25.40 x 19.05	2.625	66.70	2.625	66.70
1 1/2 x 1/2	38.10 x 12.70	2.875	73.00	2.875	73.00
1 1/2 x 3/4	38.10 x 19.05	2.875	73.00	2.875	73.00
1 1/2 x 1	38.10 x 25.40	2.875	73.00	2.875	73.00
2 x 1/2	50.80 x 12.70	3.375	85.70	3.125	79.40
2 x 3/4	50.80 x 19.05	3.375	85.70	3.125	79.40
2 x 1	50.80 x 25.40	3.375	85.70	3.125	79.40
2 x 1 1/2	50.80 x 38.10	3.375	85.70	3.125	79.40
2 1/2 x 1/2	63.50 x 12.70	3.625	92.10	3.375	85.70
2 1/2 x 3/4	63.50 x 19.05	3.625	92.10	3.375	85.70
2 1/2 x 1	63.50 x 25.40	3.625	92.10	3.375	85.70
2 1/2 x 1 1/2	63.50 x 38.10	3.625	92.10	3.375	85.70
2 1/2 x 2	63.50 x 50.80	3.625	92.10	3.375	85.70
3 x 1/2	76.20 x 12.70	3.875	98.40	3.625	92.10
3 x 3/4	76.20 x 19.05	3.875	98.40	3.625	92.10
3 x 1	76.20 x 25.40	3.875	98.40	3.625	92.10
3 x 1 1/2	76.20 x 38.10	3.875	98.40	3.625	92.10
3 x 2	76.20 x 50.80	3.875	98.40	3.625	92.10
3 x 2 1/2	76.20 x 63.50	3.875	98.40	3.625	92.10
4 x 1/2	101.60 x 12.70	4.750	120.70	4.125	104.80
4 x 3/4	101.60 x 19.05	4.750	120.70	4.125	104.80
4 x 1	101.60 x 25.40	4.750	120.70	4.125	104.80
4 x 1 1/2	101.60 x 38.10	4.750	120.70	4.125	104.80
4 x 2	101.60 x 50.80	4.750	120.70	4.375	111.10
4 x 2 1/2	101.60 x 63.50	4.750	120.70	4.375	111.10
4 x 3	101.60 x 76.20	4.750	120.70	4.375	111.10
6 x 3	152.40 x 76.20	7.125	181.00	5.375	136.50
6 x 4	152.40 x 101.60	7.125	181.00	5.750	146.10

# DT-20

## DT-4.1.2-9

Short Outlet Reducing Tee CCC

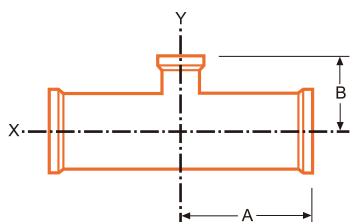

Nominal Size		A		B	
Inch	mm	Inch	mm	Inch	mm
3/8 x 1/4	9.53 x 6.35	2.250	57.20	1.000	25.40
1/2 x 1/4	12.70 x 6.35	2.375	60.30	1.000	25.40
1/2 x 3/8	12.70 x 9.53	2.375	60.30	1.000	25.40
3/4 x 1/4	19.05 x 6.35	2.500	63.50	1.000	25.40
3/4 x 3/8	19.05 x 9.53	2.500	63.50	1.000	25.40
3/4 x 1/2	19.05 x 12.70	2.500	63.50	1.000	25.40
1 x 1/4	25.40 x 6.35	2.625	66.70	1.125	28.60
1 x 3/8	25.40 x 9.53	2.625	66.70	1.125	28.60
1 x 1/2	25.40 x 12.70	2.625	66.70	1.125	28.60
1 x 3/4	25.40 x 19.05	2.625	66.70	1.125	28.60
1 1/2 x 1/2	38.10 x 12.70	2.875	73.00	1.375	34.90
1 1/2 x 3/4	38.10 x 19.05	2.875	73.00	1.375	34.90
1 1/2 x 1	38.10 x 25.40	2.875	73.00	1.375	34.90
2 x 1/2	50.80 x 12.70	3.375	85.70	1.625	41.30
2 x 3/4	50.80 x 19.05	3.375	85.70	1.625	41.30
2 x 1	50.80 x 25.40	3.375	85.70	1.625	41.30
2 x 1 1/2	50.80 x 38.10	3.375	85.70	1.625	41.30
2 1/2 x 1/2	63.50 x 12.70	3.625	92.10	1.875	47.60
2 1/2 x 3/4	63.50 x 19.05	3.625	92.10	1.875	47.60
2 1/2 x 1	63.50 x 25.40	3.625	92.10	1.875	47.60
2 1/2 x 1 1/2	63.50 x 38.10	3.625	92.10	1.875	47.60
2 1/2 x 2	63.50 x 50.80	3.625	92.10	1.875	47.60
3 x 1/2	76.20 x 12.70	3.875	98.40	2.125	54.00
3 x 3/4	76.20 x 19.05	3.875	98.40	2.125	54.00
3 x 1	76.20 x 25.40	3.875	98.40	2.125	54.00
3 x 1 1/2	76.20 x 38.10	3.875	98.40	2.125	54.00
3 x 2	76.20 x 50.80	3.875	98.40	2.125	54.00
3 x 2 1/2	76.20 x 63.50	3.875	98.40	2.125	54.00
4 x 1/2	101.60 x 12.70	4.750	120.70	2.625	66.70
4 x 3/4	101.60 x 19.05	4.750	120.70	2.625	66.70
4 x 1	101.60 x 25.40	4.750	120.70	2.625	66.70
4 x 1 1/2	101.60 x 38.10	4.750	120.70	2.625	66.70
4 x 2	101.60 x 50.80	4.750	120.70	2.625	66.70
4 x 2 1/2	101.60 x 63.50	4.750	120.70	2.625	66.70
4 x 3	101.60 x 76.20	4.750	120.70	2.625	66.70
6 x 1/2	152.40 x 12.70	7.125	181.00	3.625	92.10
6 x 3/4	152.40 x 19.05	7.125	181.00	3.625	92.10
6 x 1	152.40 x 25.40	7.125	181.00	3.625	92.10
6 x 1 1/2	152.40 x 38.10	7.125	181.00	3.625	92.10
6 x 2	152.40 x 50.80	7.125	181.00	3.625	92.10
6 x 2 1/2	152.40 x 63.50	7.125	181.00	3.625	92.10
6 x 3	152.40 x 76.20	7.125	181.00	3.625	92.10
6 x 4	152.40 x 101.60	7.125	181.00	3.750	95.30



# BPE FITTING 生技醫藥級管件

## DT-21C(a)

Concentric Reducer CC

## DT-21E(a)

Eccentric Reducer CC

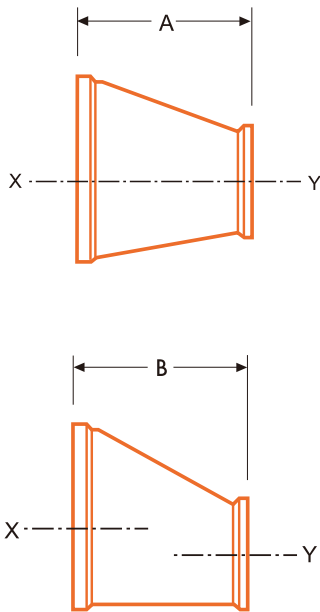

Nominal Size		CR		ER	
		A		B	
Inch	mm	Inch	mm	Inch	mm
3/4 x 1/2	19.05 x 12.70	2.000	50.80	2.000	50.80
1 x 1/2	25.40 x 12.70	2.500	63.50	2.500	63.50
1 x 3/4	25.40 x 19.05	2.000	50.80	2.000	50.80
1 1/2 x 1/2	38.10 x 12.70	3.500	88.90	3.500	88.90
1 1/2 x 3/4	38.10 x 19.05	3.000	76.20	3.000	76.20
1 1/2 x 1	38.10 x 25.40	3.000	76.20	3.000	76.20
2 x 1/2	50.80 x 12.70	5.500	139.70	5.500	139.70
2 x 3/4	50.80 x 19.05	5.000	127.00	5.000	127.00
2 x 1	50.80 x 25.40	5.000	127.00	5.000	127.00
2 x 1 1/2	50.80 x 38.10	3.000	76.20	3.000	76.20
2 1/2 x 1/2	63.50 x 12.70	7.500	190.50	7.500	190.50
2 1/2 x 3/4	63.50 x 19.05	7.000	177.80	7.000	177.80
2 1/2 x 1	63.50 x 25.40	7.000	177.80	7.000	177.80
2 1/2 x 1 1/2	63.50 x 38.10	5.000	127.00	5.000	127.00
2 1/2 x 2	63.50 x 50.80	3.000	76.20	3.000	76.20
3 x 1	76.20 x 25.40	9.000	228.60	9.000	228.60
3 x 1 1/2	76.20 x 38.10	7.000	177.80	7.000	177.80
3 x 2	76.20 x 50.80	5.000	127.00	5.000	127.00
3 x 2 1/2	76.20 x 63.50	3.000	76.20	3.000	76.20
4 x 1	101.60 x 25.40	13.125	333.40	13.125	333.40
4 x 1 1/2	101.60 x 38.10	11.125	282.60	11.125	282.60
4 x 2	101.60 x 50.80	9.125	231.80	9.125	231.80
4 x 2 1/2	101.60 x 63.50	7.125	181.00	7.125	181.00
4 x 3	101.60 x 76.20	5.125	130.20	5.125	130.20
6 x 3	152.40 x 76.20	7.500	190.50	7.625	193.70
6 x 4	152.40 x 101.60	7.625	193.70	7.625	193.70

## DT-22A

## DT-22B

## DT-22C

DT-4.1.4-1

Ferrule

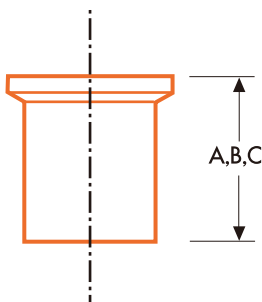

Nominal Size		A		B		C	
Inch	mm	Inch	mm	Inch	mm	Inch	mm
1/4	6.35	1.750	44.50	1.130	28.70	0.500	12.70
3/8	9.53	1.750	44.50	1.130	28.70	0.500	12.70
1/2	12.70	1.750	44.50	1.130	28.70	0.500	12.70
3/4	19.05	1.750	44.50	1.130	28.70	0.500	12.70
1	25.40	1.750	44.50	1.130	28.70	0.500	12.70
1 1/2	38.10	1.750	44.50	1.130	28.70	0.500	12.70
2	50.80	2.250	57.20	1.130	28.70	0.500	12.70
2 1/2	63.50	2.250	57.20	1.130	28.70	0.500	12.70
3	76.20	2.250	57.20	1.130	28.70	0.500	12.70
4	101.60	2.250	57.20	1.130	28.70	0.625	15.90
6	152.40	3.000	76.20	1.500	38.10	0.750	19.10



# DT-23

DT-4.1.1-7

180° Return Bend WW

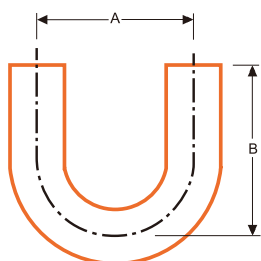

Nominal Size		A		B	
Inch	mm	Inch	mm	Inch	mm
1/4	6.35	4.500	114.30	2.625	66.70
3/8	9.53	4.500	114.30	2.625	66.70
1/2	12.70	4.500	114.30	3.000	76.20
3/4	19.05	4.500	114.30	3.000	76.20
1	25.40	3.000	76.20	3.000	76.20
1 1/2	38.10	4.500	114.30	4.500	114.30
2	50.80	6.000	152.40	5.000	127.00
2 1/2	63.50	7.500	190.50	5.750	146.10
3	76.20	9.000	228.60	6.500	165.10
4	101.60	12.000	304.80	8.500	215.90
6	152.40	18.000	457.20	11.500	292.10

# DT-23T

180° Tee Bottom

Outlet WCW

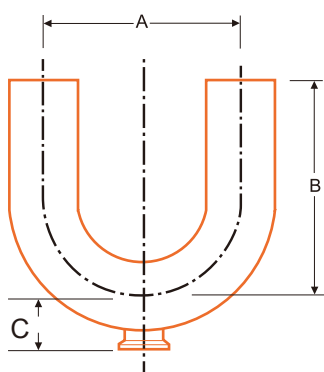

Nominal Size		A		B		C	
Inch	mm	Inch	mm	Inch	mm	Inch	mm
1 x 1/2	25.40 x 12.70	3.000	76.20	3.000	76.20	1.125	28.58
1 x 3/4	25.40 x 19.05	3.000	76.20	3.000	76.20	1.125	28.58
1 x 1	25.40 x 25.40	3.000	76.20	3.000	76.20	1.125	28.58
1 1/2 x 1/2	38.10 x 12.70	4.500	114.30	4.500	114.30	1.375	34.93
1 1/2 x 3/4	38.10 x 19.05	4.500	114.30	4.500	114.30	1.375	34.93
1 1/2 x 1	38.10 x 25.40	4.500	114.30	4.500	114.30	1.375	34.93
1 1/2 x 1 1/2	38.10 x 38.10	4.500	114.30	4.500	114.30	1.375	34.93
2 x 1/2	50.80 x 12.70	6.000	152.40	5.000	127.00	1.625	41.28
2 x 3/4	50.80 x 19.05	6.000	152.40	5.000	127.00	1.625	41.28
2 x 1	50.80 x 25.40	6.000	152.40	5.000	127.00	1.625	41.28
2 x 1 1/2	50.80 x 38.10	6.000	152.40	5.000	127.00	1.625	41.28
2 x 2	50.80 x 50.80	6.000	152.40	5.000	127.00	1.625	41.28
2 1/2 x 1/2	63.50 x 12.70	7.500	190.50	5.750	146.05	1.875	47.63
2 1/2 x 3/4	63.50 x 19.05	7.500	190.50	5.750	146.05	1.875	47.63
2 1/2 x 1	63.50 x 25.40	7.500	190.50	5.750	146.05	1.875	47.63
2 1/2 x 1 1/2	63.50 x 38.10	7.500	190.50	5.750	146.05	1.875	47.63
2 1/2 x 2	63.50 x 50.80	7.500	190.50	5.750	146.05	1.875	47.63
2 1/2 x 2 1/2	63.50 x 63.50	7.500	190.50	5.750	146.05	1.875	47.63
3 x 1/2	76.20 x 12.70	9.000	228.60	6.500	165.10	2.125	53.98
3 x 3/4	76.20 x 19.05	9.000	228.60	6.500	165.10	2.125	53.98
3 x 1	76.20 x 25.40	9.000	228.60	6.500	165.10	2.125	53.98
3 x 1 1/2	76.20 x 38.10	9.000	228.60	6.500	165.10	2.125	53.98
3 x 2	76.20 x 50.80	9.000	228.60	6.500	165.10	2.125	53.98
3 x 2 1/2	76.20 x 63.50	9.000	228.60	6.500	165.10	2.125	53.98
3 x 3	76.20 x 76.20	9.000	228.60	6.500	165.10	2.125	53.98
4 x 1/2	101.60 x 12.70	12.000	304.80	8.500	215.90	2.625	66.68
4 x 3/4	101.60 x 19.05	12.000	304.80	8.500	215.90	2.625	66.68
4 x 1	101.60 x 25.40	12.000	304.80	8.500	215.90	2.625	66.68
4 x 1 1/2	101.60 x 38.10	12.000	304.80	8.500	215.90	2.625	66.68
4 x 2	101.60 x 50.80	12.000	304.80	8.500	215.90	2.625	66.68
4 x 2 1/2	101.60 x 63.50	12.000	304.80	8.500	215.90	2.625	66.68
4 x 3	101.60 x 76.20	12.000	304.80	8.500	215.90	2.625	66.68
4 x 4	101.60 x 101.60	12.000	304.80	8.500	215.90	2.625	66.68



# BPE FITTING 生技醫藥級管件

## DT-24

DT-4.1.1-8

180° Return Bend CC

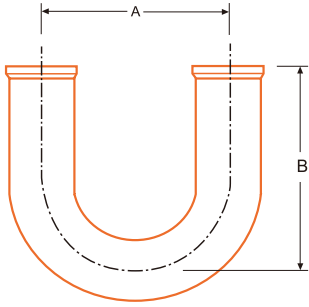

Nominal Size		A		B	
Inch	mm	Inch	mm	Inch	mm
1/4	6.35	4.500	114.30	3.125	79.40
3/8	9.53	4.500	114.30	3.125	79.40
1/2	12.70	4.500	114.30	3.500	88.90
3/4	19.05	4.500	114.30	3.500	88.90
1	25.40	3.000	76.20	3.500	88.90
1 1/2	38.10	4.500	114.30	5.000	127.00
2	50.80	6.000	152.40	5.500	139.70
2 1/2	63.50	7.500	190.50	6.250	158.80
3	76.20	9.000	228.60	7.000	177.80
4	101.60	12.000	304.80	9.125	231.80
6	152.40	18.000	457.20	13.000	330.20

## DT-25

DT-4.1.2-3

Short Outlet Run Tee WWC

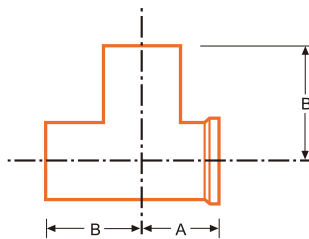

Nominal Size		A		B	
Inch	mm	Inch	mm	Inch	mm
1/4	6.35	0.875	22.20	1.750	44.50
3/8	9.53	0.875	22.20	1.750	44.50
1/2	12.70	0.875	22.20	1.875	47.60
3/4	19.05	1.000	25.40	2.000	50.80
1	25.40	1.125	28.60	2.125	54.00
1 1/2	38.10	1.375	34.90	2.375	60.30
2	50.80	1.625	41.30	2.875	73.00
2 1/2	63.50	1.875	47.60	3.125	79.40
3	76.20	2.125	54.00	3.375	85.70
4	101.60	2.750	69.90	4.125	104.80
6	152.40	4.625	117.50	5.625	142.90

# DT-26C(a)

Concentric Reducer CW

# DT-26E(a)

Eccentric Reducer CW

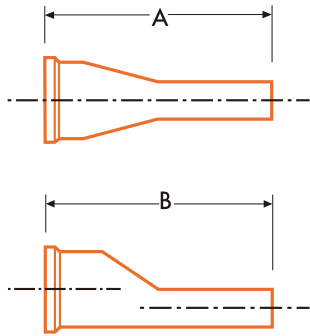

Nominal Size		A		B	
Inch	mm	Inch	mm	Inch	mm
3/4 x 1/2	19.05 x 12.70	3.000	76.20	3.000	76.20
1 x 1/2	25.40 x 12.70	3.500	88.90	3.500	88.90
1 x 3/4	25.40 x 19.05	3.000	76.20	3.000	76.20
1 1/2 x 1/2	38.10 x 12.70	4.500	114.30	4.500	114.30
1 1/2 x 3/4	38.10 x 19.05	4.000	101.60	4.000	101.60
1 1/2 x 1	38.10 x 25.40	4.000	101.60	4.000	101.60
2 x 1/2	50.80 x 12.70	6.500	165.10	6.500	165.10
2 x 3/4	50.80 x 19.05	6.000	152.40	6.000	152.40
2 x 1	50.80 x 25.40	6.000	152.40	6.000	152.40
2 x 1 1/2	50.80 x 38.10	4.000	101.60	4.000	101.60
2 1/2 x 1/2	63.50 x 12.70	8.500	215.90	8.500	215.90
2 1/2 x 3/4	63.50 x 19.05	8.000	203.20	8.000	203.20
2 1/2 x 1	63.50 x 25.40	8.000	203.20	8.000	203.20
2 1/2 x 1 1/2	63.50 x 38.10	6.000	152.40	6.000	152.40
2 1/2 x 2	63.50 x 50.80	4.250	108.00	4.250	108.00
3 x 1	76.20 x 25.40	10.000	254.00	10.000	254.00
3 x 1 1/2	76.20 x 38.10	8.000	203.20	8.000	203.20
3 x 2	76.20 x 50.80	6.250	158.80	6.250	158.80
3 x 2 1/2	76.20 x 63.50	4.250	108.00	4.250	108.00
4 x 1	101.60 x 25.40	14.125	358.80	14.125	358.80
4 x 1 1/2	101.60 x 38.10	12.125	308.00	12.125	308.00
4 x 2	101.60 x 50.80	10.375	263.50	10.375	263.50
4 x 2 1/2	101.60 x 63.50	8.375	212.70	8.375	212.70
4 x 3	101.60 x 76.20	6.375	161.90	6.375	161.90
6 x 3	152.40 x 76.20	9.000	228.60	8.750	222.30
6 x 4	152.40 x 101.60	9.000	228.60	9.000	228.60

# DT-27

DT-4.1.2-5

Short Outlet Tee CCC

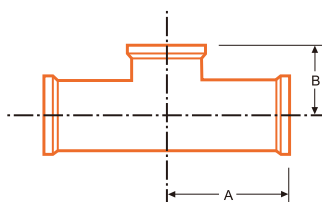

Nominal Size		A		B	
Inch	mm	Inch	mm	Inch	mm
1/2	12.70	2.250	57.20	1.000	25.40
3/4	19.05	2.350	60.70	1.125	28.60
1	25.40	2.625	66.70	1.125	28.60
1 1/2	38.10	2.875	73.00	1.375	34.90
2	50.80	3.375	85.70	1.625	41.30
2 1/2	63.50	3.625	92.10	1.875	47.60
3	76.20	3.875	98.40	2.125	54.00
4	101.60	4.750	120.70	2.750	69.90
6	152.40	7.125	181.00	4.625	117.50



# BPE FITTING 生技醫藥級管件

## DT-28

DT-4.1.2-10

Instrument Tee WCW

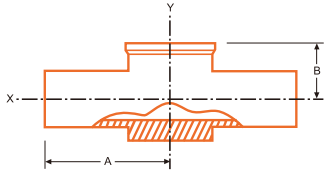

Nominal Size		A		B	
Inch	mm	Inch	mm	Inch	mm
1/2 x 1 1/2	12.70 x 38.10	2.500	63.50	0.875	22.20
3/4 x 1 1/2	19.05 x 38.10	2.500	63.50	1.000	25.40
1 x 1 1/2	25.40 x 38.10	2.500	63.50	1.125	28.60
1/2 x 2	12.70 x 50.80	2.750	69.90	1.000	25.40
3/4 x 2	19.05 x 50.80	2.750	69.90	1.125	28.60
1 x 2	25.40 x 50.80	2.750	69.90	1.250	31.80
1 1/2 x 2	38.10 x 50.80	2.750	69.90	1.500	38.10

## DT-29

DT-4.1.2-11

Instrument Tee CCC

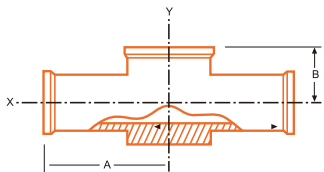

Nominal Size		A		B	
Inch	mm	Inch	mm	Inch	mm
1/2 x 1 1/2	12.70 x 38.10	3.000	76.20	0.875	22.20
3/4 x 1 1/2	19.05 x 38.10	3.000	76.20	1.000	25.40
1 x 1 1/2	25.40 x 38.10	3.000	76.20	1.125	28.60
1/2 x 2	12.70 x 50.80	3.250	82.60	1.000	25.40
3/4 x 2	19.05 x 50.80	3.250	82.60	1.125	28.60
1 x 2	25.40 x 50.80	3.250	82.60	1.250	31.80
1 1/2 x 2	38.10 x 50.80	3.250	82.60	1.500	38.10

## DT-30

DT-4.1.5-1

Tube Weld End Cap

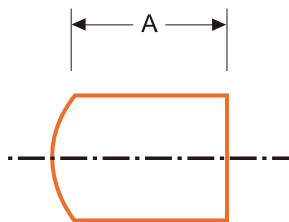

Nominal Size		A	
Inch	mm	Inch	mm
1/2	12.70	1.500	38.10
3/4	19.05	1.500	38.10
1	25.40	1.500	38.10
1 1/2	38.10	1.500	38.10
2	50.80	1.500	38.10
2 1/2	63.50	1.500	38.10
3	76.20	1.750	44.50
4	101.60	2.000	50.80
6	152.40	2.500	63.50

## DT-31

DT-4.1.5-2

Solid End Cap

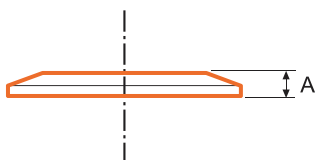

Nominal Size		A	
Inch	mm	Inch	mm
1/4	6.35	0.187	4.70
3/8	9.53	0.187	4.70
1/2 & 3/4	12.70, 19.05	0.187	4.70
1 & 1 1/2	25.40, 38.10	0.250	6.40
2	50.80	0.250	6.40
2 1/2	63.50	0.250	6.40
3	76.20	0.250	6.40
4	101.60	0.312	7.90
6	152.40	0.437	11.10

# BUTTERFLY VALVE 蝶閥

下拉把手型式

Trigger Handle Type

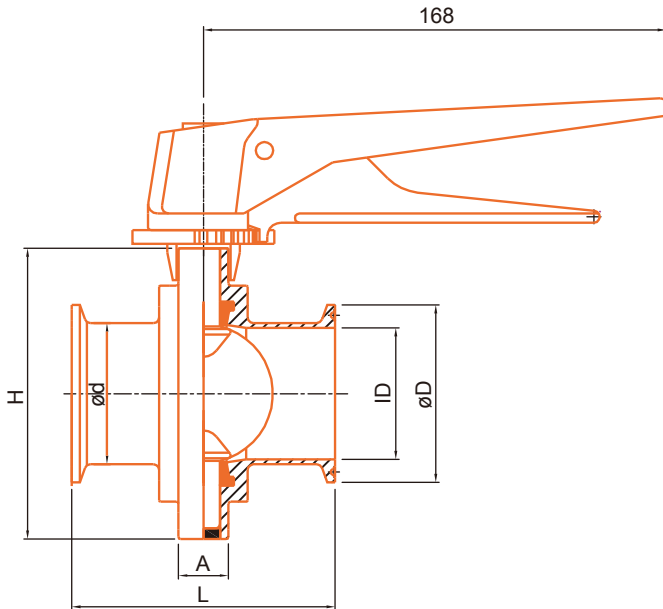

## Technical data

Max. product pressure : 10 bar  
Working temperature : -10°C~140°C (EPDM)

Material

Product wetted stainless steel parts : SS304 or SS316L  
Finish : Semi-bright  
Other stainless steel parts : SS304  
Seal : Silicone, EPDM or VITON®

ITEM	PARTS	MATERIAL	QTY
1	Notch plate	SS304/SS316L	1
2	Disc	SS304/SS316L	1
3	Seal	Silicone/EPDM/VITON®	1
4	Notch plate	SS304	2
5	Screw (M6x12)	SS304	1
6	Trigger	SS304	1
7	Handle	Nylon/SS304	1
8	Spring	SS304	1
9	Pin	SS304	4

## Open/Shut Torque

Nominal Size	Max. Torque
Inch	Nm
1	15
1 1/2	15
2	20
2 1/2	25
3	30
4	35

Ordering information

Valve type  
Valve size  
Connection type  
Material grade  
Seal material  
Handle type  
Actuation type

Size	ID	ØD	Ød	A	L	H
	mm	mm	mm	mm	mm	mm
1.0"	22.10	50.50	25.40	18.00	77.40	78.00
1.5"	34.80	50.50	38.10	18.00	77.40	85.00
2.0"	47.50	64.00	50.80	18.00	77.40	100.00
2.5"	60.20	77.40	63.50	18.00	81.40	115.00
3.0"	72.90	91.00	76.20	18.00	85.40	126.00
4.0"	97.40	119.00	101.60	22.00	103.80	159.00



# BUTTERFLY VALVE 蝶閥

## 側拉蝶閥

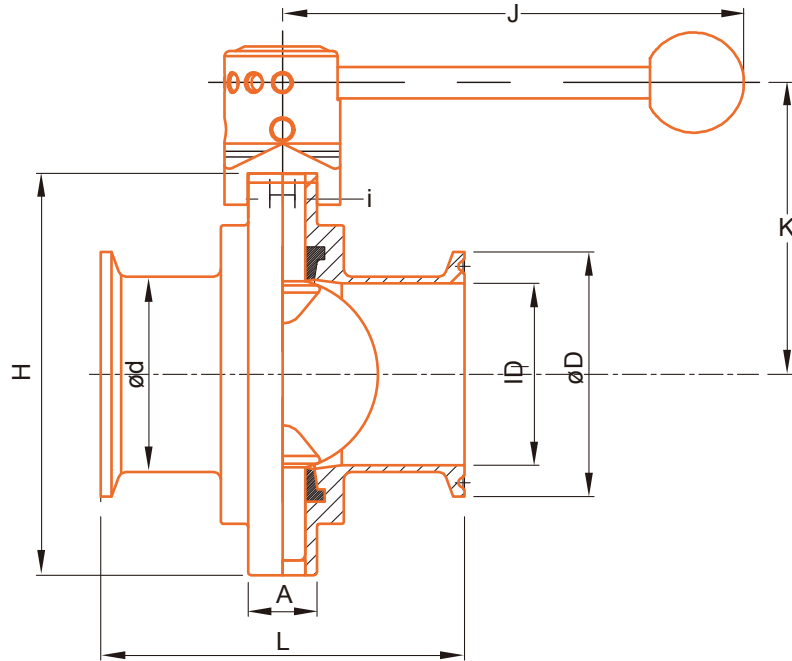

SIZE	ID	ØD	Ød	A	L	H	I	J	K
1.0"	22.10	50.50	25.40	18.00	77.40	78.00	8x10	127.00	66.00
1.5"	34.80	50.50	38.10	18.00	77.40	85.00	8x10	127.00	68.50
2.0"	47.50	64.00	50.80	18.00	77.40	100.00	8x10	135.00	76.50
2.5"	60.20	74.40	63.50	18.00	81.40	115.00	8x10	135.00	84.50
3.0"	72.90	91.00	76.20	18.00	85.40	126.00	8x10	160.00	91.00
4.0"	97.40	119.00	101.60	22.00	103.80	159.00	10x10	160.00	113.00

## 臥式氣動蝶閥

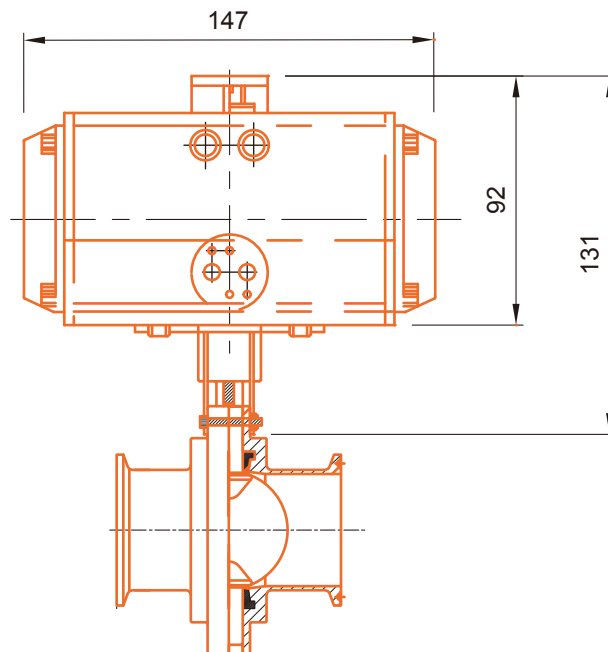

# ACTUATOR 汽缸

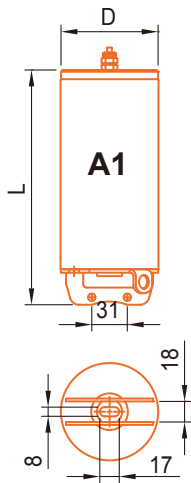

## Technical data

A1/A3 shut-off time: 1.5 seconds

A1/A3 weight: 3.85 KGS.

A104 shut-off time: 1.7 seconds

A104 weight: 4.7 KGS.

A1/A104 can be connected with M12 screw proximity switch (PNP or NPN)

A3 can be connected with either M12 screw proximity switch (PNP or NPN) or control box.

Max. air pressure: 7 bar

Min. air pressure for NC and NO: 5 bar

Working temperature: -25°C~90°C

## Material

Actuator body: SS304

Piston: POM

Seal: NBR

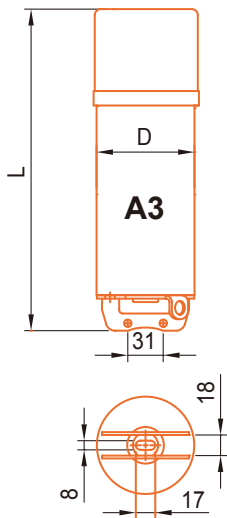

Model	For Butterfly Valve	D	L
No.	Size	mm	mm
A1	1"-3"	85	205
A3	1"-3"	85	274
A104	4"	120	335

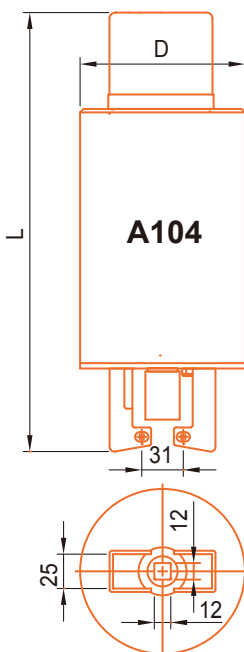

## A3 Pneumatic Butterfly Valve with Control Box Set

Air/Spring actuator with single or double action

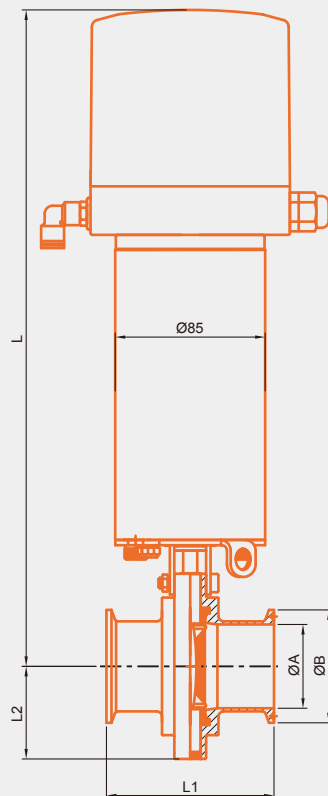

Nominal Size	A	B	C	L
Inch	mm	mm	mm	mm
A1	22	50	44	357
A3	35	50	44	360
A104	47	64	47	370
A3	60	77	49	373
A104	72	91	52	380



# 3 PIECES BALL VALVE 三片式球閥

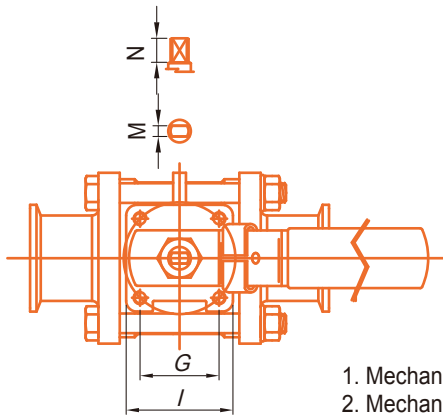

1. Mechanically Polished  $\leq Ra0.4$
2. Mechanically Polished and Electro Polished  $\leq Ra0.4$
3. Full Cavity filled seats

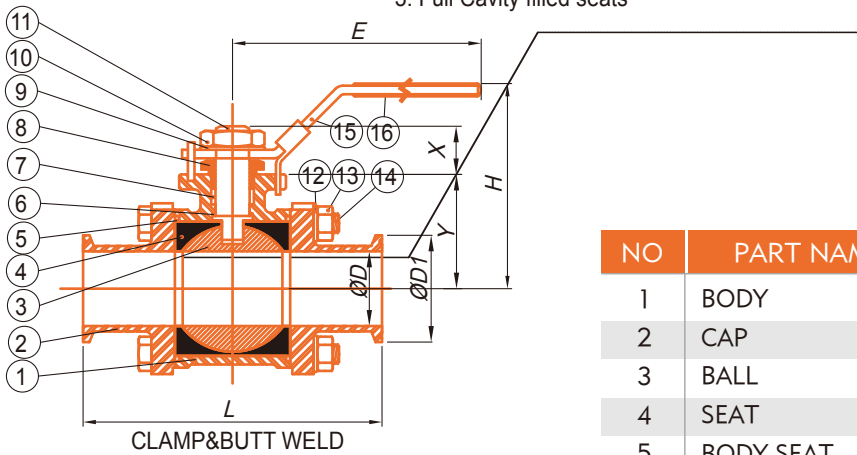

## PRESSURE TEMPERATURE RATING

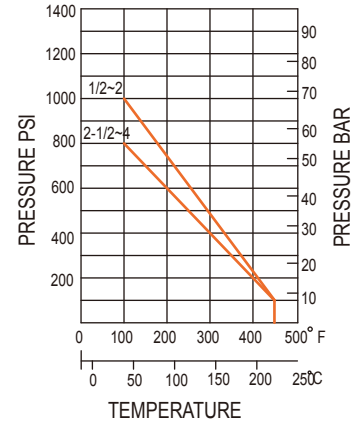

NO	PART NAME	QTY	MATERIAL
1	BODY	1	ASTM CF8/CF8M/CF3M
2	CAP	2	ASTM CF8/CF8M/CF3M
3	BALL	1	ASTM CF8/CF8M/CF3M
4	SEAT	2	PTFE/TFM
5	BODY SEAT	2	PTFE
6	THRUST WASHER	1	PTFE
7	STEM PACKING	1	PTFE
8	GLAND NUT	1	AISI 304
9	STEM WASHER	1	AISI 304
10	STEM NUT	1	AISI 304
11	STEM	1	AISI 304/316
12	BOLT WASHER	4,8,12	AISI 304
13	NUT	4,8,12	AISI 304
14	BOLT	4,6	AISI 304
15	HANDLE	1	AISI 304
16	PLASTIC COVER	1	PLASTIC

DN	SIZE IN	ISO-5211	ØD ±0.2	L ±1.0	H ±3.0	E ±3.0	ØD1	G	I	Y	M	TORQUE INCH/LBS
15	1/2	F03 36	9.5	89	55	132	25.5	25.5	36	25	5	50
20	3/4	F03 36	15.9	101	60	132	25.5	25.5	36	29	5	80
25	1	F04 42	22.2	114	69	165	50.4	29.7	42	37	6.5	120
40	1-1/2	F05 50	35.0	140	84	194	50.4	35.4	50	50	8.5	260
50	2	F05 50	47.6	156	92	194	63.6	35.4	50	57	8.5	350
65	2-1/2	F07 70	60.2	197	127	252	77.5	49.5	68	77	12	410
80	3	F07 70	73.0	229	136	252	90.8	49.5	68	85	12	580
100	4	F10 102	97.4	243	159	333	118.5	72.1	92	106	16	1560



# Mount Actuator For Ball Valve 氣動高平台衛生級及製藥級球閥

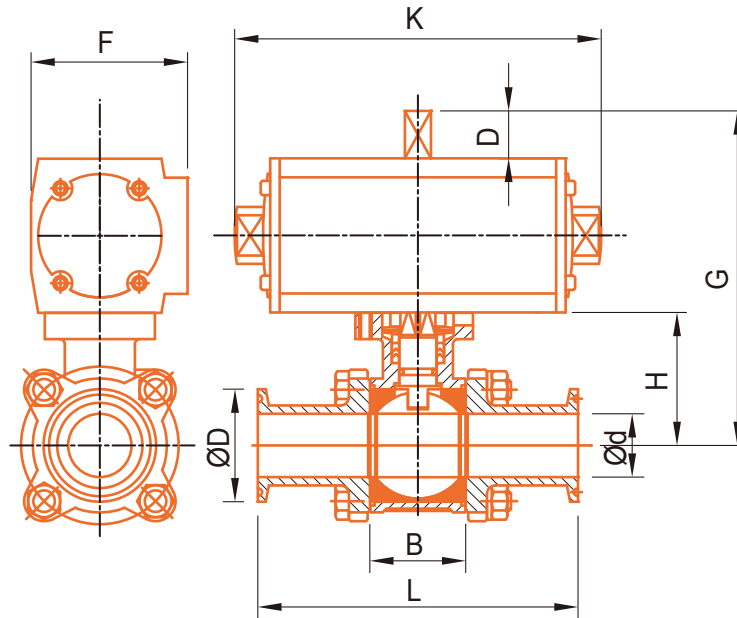

## Materials:

- ASTM-CF8M A351

## Seat:

- PTFE/PTFE+15% GF.

## BALL VALVE/SERIES 26

Size	DN	Ød mm	ISO-5211	ØD mm	L mm	H mm	Model	D mm	F mm	G mm	K mm	TORQUE INCH/LBS
1/2"	15	9.5	F03/F04	25.4	89	37	ES50DA	21	67.8	107	162	50
3/4"	20	15.9	F03/F04	25.4	101	47	ES50DA	21	67.8	117	162	75
1"	25	22.2	F04/F05	50.4	114	57.2	ES50DA	21	67.8	143	162	100
1-1/2"	40	35	F05/F07	50.4	140	78.2	ES63DA	21	80.5	182	169	190
2"	50	47.6	F05/F07	63.9	156	86.2	ES75DA	21	90.5	190	217	240
2-1/2"	65	60.3	F07/F10	77.5	197	109.2	ES85DA	21	99	230	257	420
3"	80	73	F07/F10	90.9	229	117.7	ES100DA	21	99	264.5	257	480
4"	100	97.4	F10/F12	118.9	243	141.2	ES125DA	21	138	288	347	1200



# 3PC Tank Bottom Valve 球式桶底閥

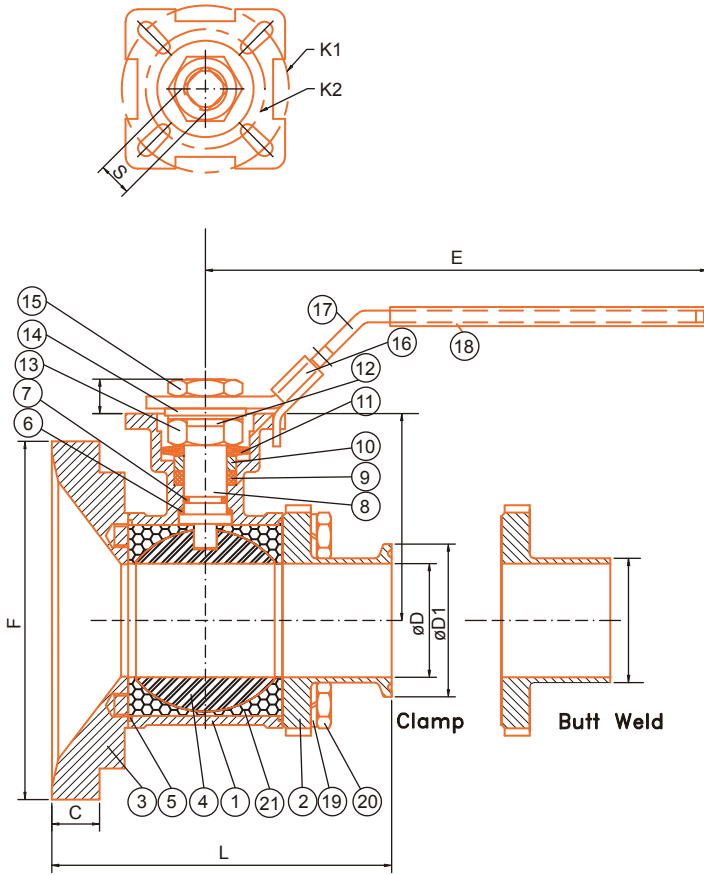

NO	PART NAME	QTY	MATERIAL
1	Body	1	CF3M/CF8M
2	Cap 1	1	CF3M/CF8M
3	Cap 2	1	CF3M/CF8M
4	Solid ball	1	CF3M/CF8M
5	Body seal	2	PTFE
6	Stem seal	1	PTFE
7	O-Ring	1	Viton
8	Stem	1	SS316/316L
9	Stem packing	1	PTFE
10	Gland ring	2	SS304
11	Belleville spring	1	SS301
12	Saddle washer	1	SS304
13	Nut	1	SS304
14	Spacer	1	SS304
15	Handle nut	1	SS304
16	Locking device	1	SS304
17	Handle	1	SS304
18	Handle cover	1	Plastic
19	Spring washer	4.6	SS304
20	Bolt	4.6	SS304
21	Ball Seat	2	PTFE

Size	mm	inch	ØD	L	H	E	T	S	D1	F	ISO5211		C	D2
											ØK1	ØK2		
25		1"	22.2	94	57.2	154	11	11	50.4	100	F04	F05	10	25.4
40		1-1/2"	35	122.5	77.5	184	14	14	50.4	140	F05	F07	12.5	38.1
50		2"	47.6	142	86.5	184	14	14	63.8	150	F05	F07	20	50.8

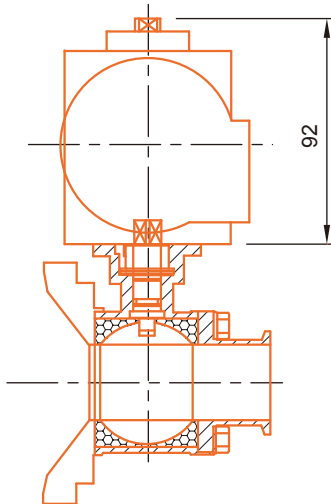

# 3-WAY BALL VALVE (L PORT & T PORT) 三通球閥

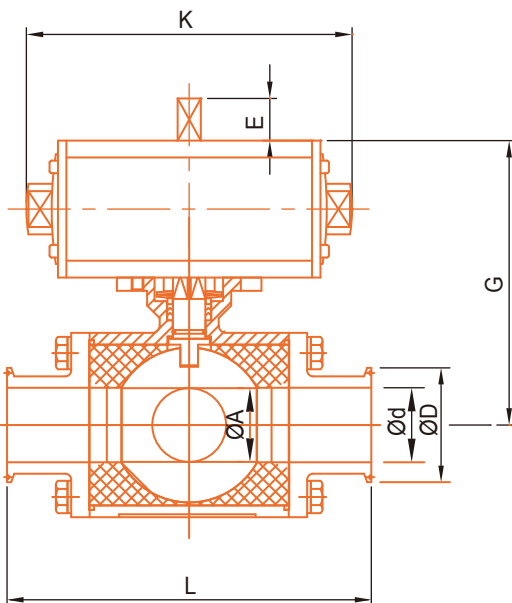
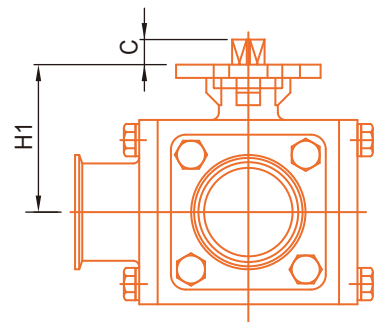
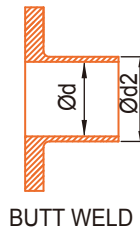
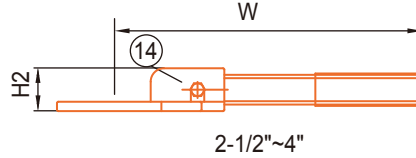
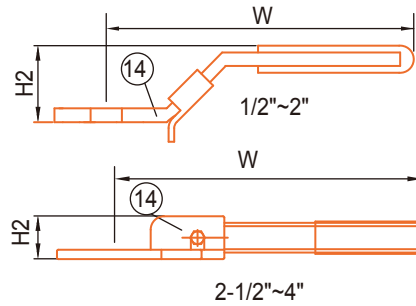
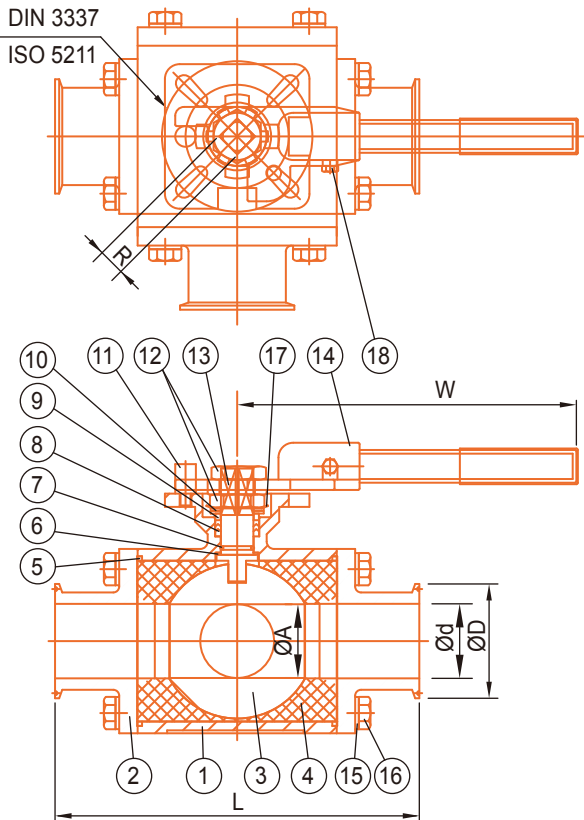

## SERIES:Y-4HCS

FOUR PIECE THREE WAY MULTI-PORT 1000 WOG SANITARY BALL VALVE TRI-CLAMP END T/T/T  
FEATURES:

- BLOW-OUT PROOF STEM/SOLID BALL
- LOCKING HANDLE
- INVESTMENT CAST STAINLESS STEEL CF8M OR CF3M
- BALL AND END POLISHED RATE 20RA
- FULL CAVITY FILLED PTFE SEATS
- BALL:T-PORT AND L-PORT
- LONG-NECK ISO 5211 MOUNTING PAD ENABLES TO INSTALL ACTUATOR DIRECTLY
- SIZE:AVAILABLE FROM 1/2" TO 4"

TURN	0°	90°	180°	270°
L				
T				

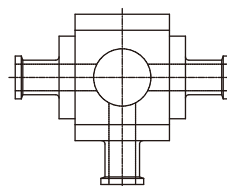

T PORT

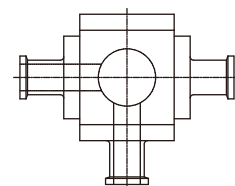

L PORT



# 3-WAY BALL VALVE (L PORT & T PORT) 三通球阀

## PRESSURE TEMPERATURE RATING

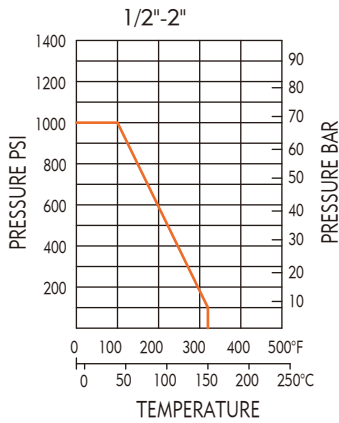

## PRESSURE TEMPERATURE RATING

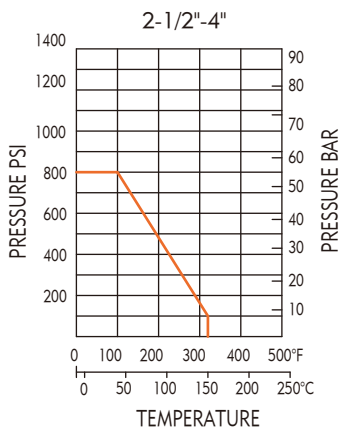

NO	PART NAME	QTY	MATERIAL
1	BODY	1	A351-CF8M / CF3M
2	CAP	4	A351-CF8M / CF3M
3	BALL	1	A351-CF8M / CF3M
4	SEAT	4	PTFE / TFM-1600
5	GASKET	2	PTFE / TFM-1600
6	THRUST WASHER	1	PTFE / TFM-1600
7	O-RING	1	VITON
8	STEM PACKING	1	PTFE / TFM-1600
9	RING	1	AISI 304
10	BEVEL WASHER	2	AISI 304
11	STOP PIN	1	AISI 304
12	NUT	2	AISI 304
13	STEM	1	AISI 316 / AISI 316L
14	HANDLE	1	AISI 304
15	SPRING WASHER	16	AISI 304
16	BOLT	16	AISI 304
17	PREVAILING DEVICE	1	AISI 304
18	NUT	1	AISI 304

SIZE	DN	W	H1	H2	C	Model	E	G	K
1/2"	15	121	41	36	9	ES50DA	21	93.5	162
3/4"	20	121	48	36	9	ES50DA	21	97	162
1"	25	137	57	33	11	ES63DA	21	124	169
1-1/2"	40	182	72	37	14	ES75DA	21	155	217
2"	50	182	80	37	14	ES75DA	21	165	217
2-1/2"	65	370	98	29	17	ES85DA	21	200	257
3"	80	400	126	32	23	ES100DA	21	251.5	282
4"	100	400	126	32	23	ES125DA	21	261.5	347

SIZE	DN	ISO-5211	ØA	Ød	ØD	Ød2	L	R	TORQUE IN/LBS
1/2"	15	F03/F04	9.5	9.5	25.4	12.7	118.0	9	79
3/4"	20	F03/F04	15.8	15.8	25.4	19.1	127.0	9	85
1"	25	F04/F05	22.2	22.2	50.4	25.4	152.6	11	110
1-1/2"	40	F05/F07	35.0	35.0	50.4	38.1	175.0	14	290
2"	50	F05/F07	47.6	47.6	63.9	50.8	190	14	680
2-1/2"	65	F07/F10	60.2	60.2	77.5	63.5	227.7	17	1060
3"	80	F10/F12	73.0	73.0	90.9	76.2	260.6	22	1770
4"	100	F10/F12	97.4	97.4	118.9	101.6	290	22	1900

# CHECK VALVE 逆止閥

## Inch Size Check Valve Weld End 焊式逆止閥

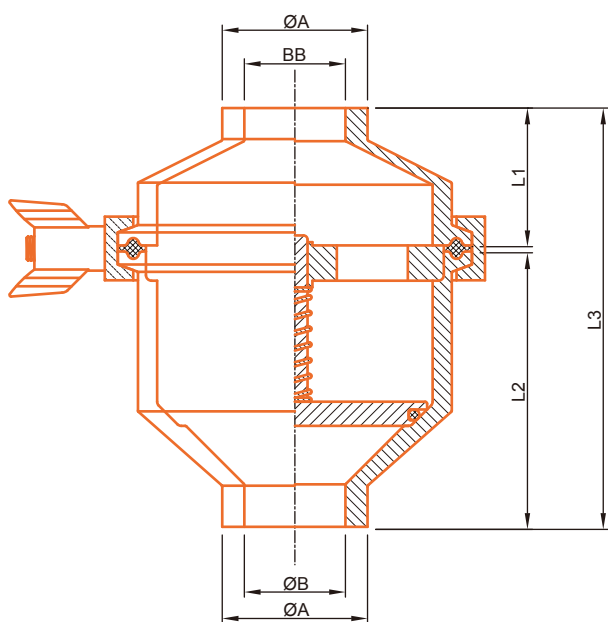

Size	ØA	ØB	L1	L2	L3
1"	25.4	22.2	30.0	46.0	77.5
1.5"	38.1	34.6	31.0	48.0	80.5
2"	50.8	47.5	31.0	53.0	85.5
2.5"	63.5	60.2	35.0	60.0	96.5
3"	76.2	72.8	35.0	68.0	104.5
4"	101.6	97.6	35.0	68.0	104.5

## Inch Size Check Valve Clamp End 夾式逆止閥

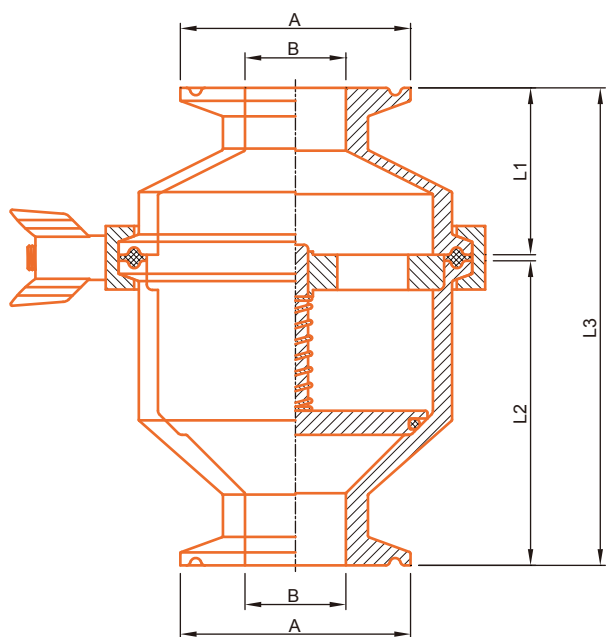

Size	ØA	ØB	L1	L2	L3
1"	50.50	22.2	33.0	53.0	87.5
1.5"	50.50	34.6	39.0	55.0	95.5
2"	64.0	47.5	40.0	63.0	104.5
2.5"	77.5	60.2	44.7	70.0	116.2
3"	91.0	72.8	45.0	77.0	123.5
4"	119.0	97.6	50.0	72.0	123.5



# SAMPLE VALVE 取樣閥

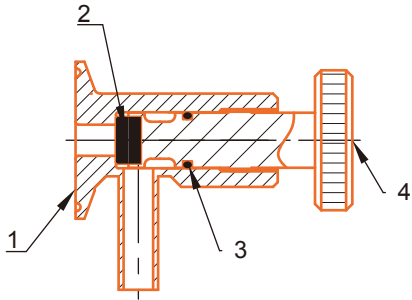

N0	PART NAME	QTY
1	Body	1
2	Seal	1
3	O-Ring	1
4	Screw Shaft	1

## Materials:

- Steel part: Stainless steel  
SS304 or SS316L
- Seal: Teflon
- O-Ring: EPDM

## L Type

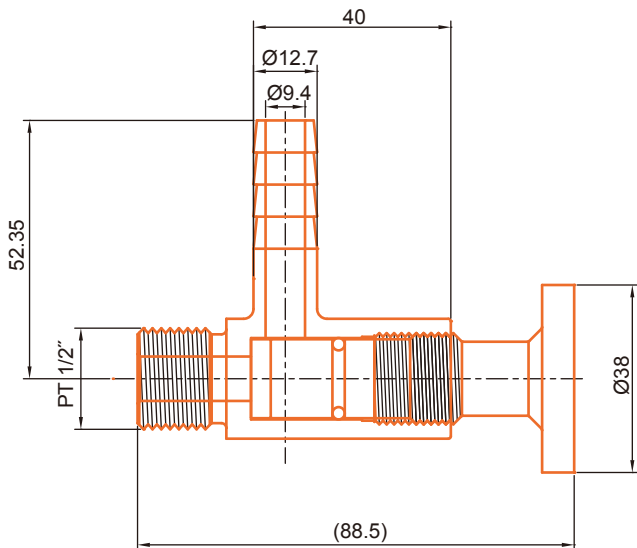
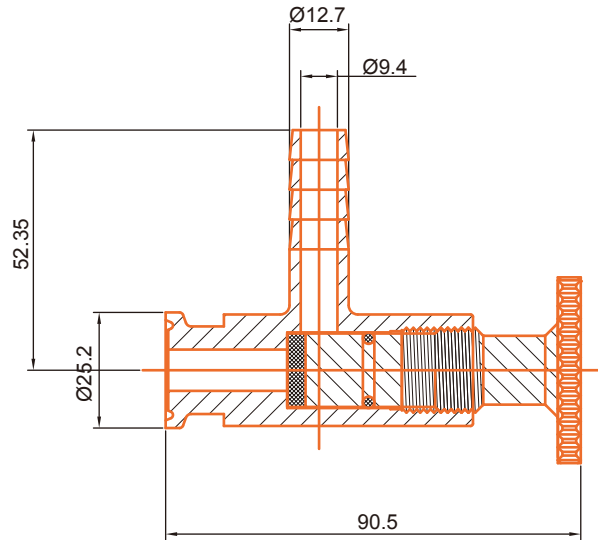
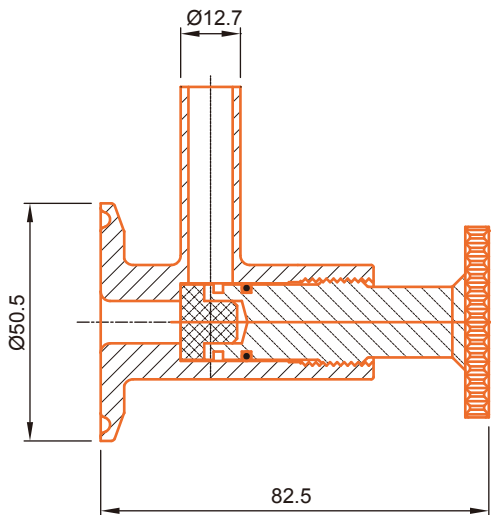

## Y Type

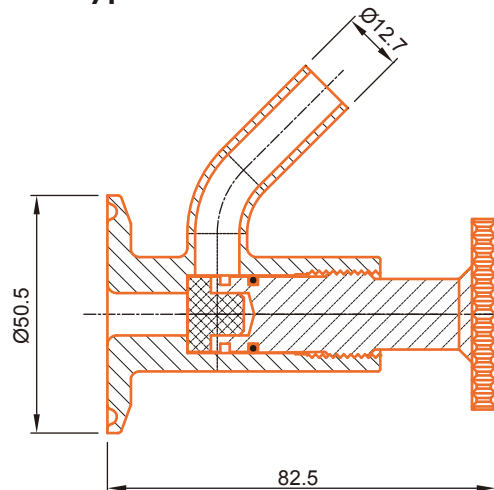

# Spray Ball 噴球

## Fixed 360° Weld End Spray Ball 固定式噴球

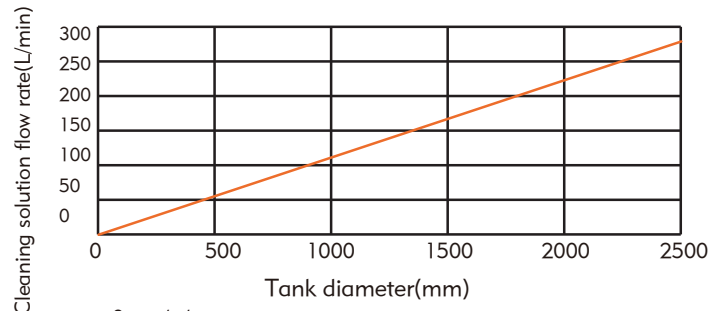
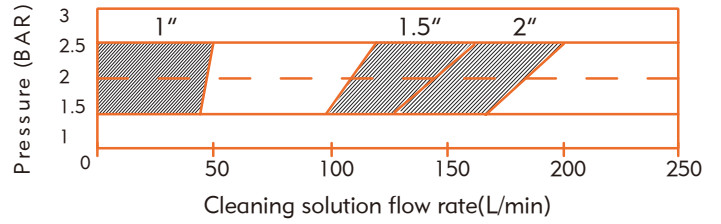
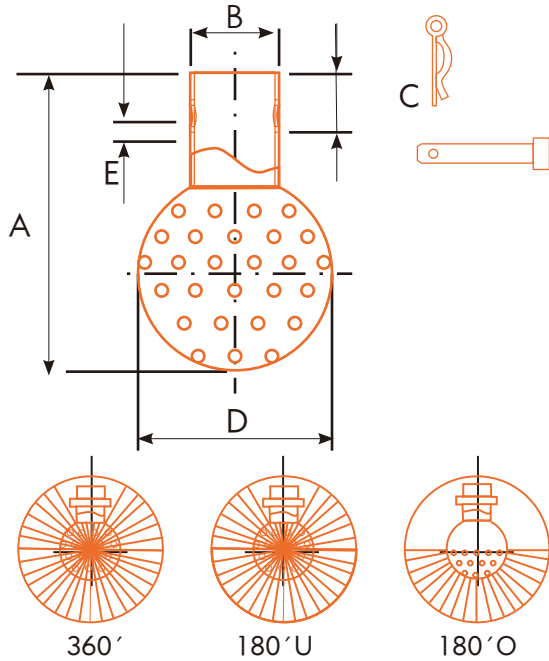

2 mm holes  
Typically use in food and beverage for cleaning storage tanks  
Stationary : Designed to be mounted to a tube or pipe  
Various spray patterns available  
Other dimensions, connection types and pin types available upon request

Nominal Size	A	B	C	D	E
Inch	mm	mm	mm	mm	mm
3/4	61	22	9	45	6
1	90	26	14.8	64	6
1 1/2	116	38.5	14.8	64	6
2	121	51.5	19.8	91	6

## Rotary 360° Clip-on Locking Pin Spray Ball 旋轉式噴球

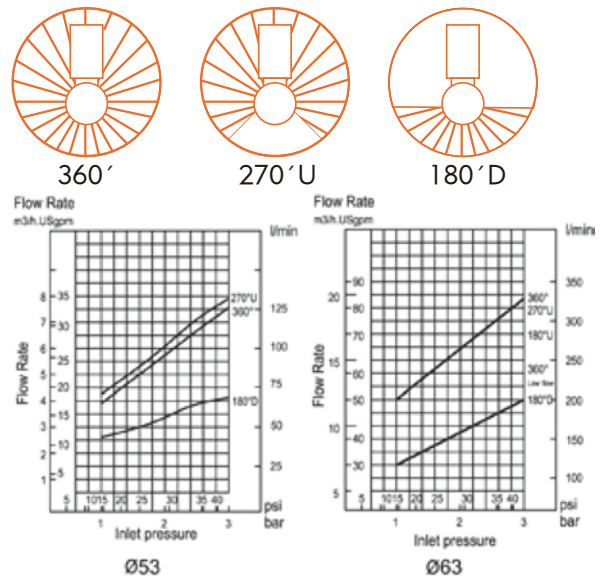
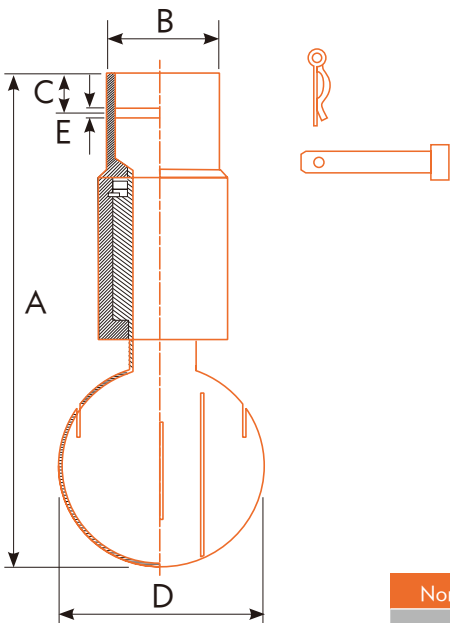

Nominal Size	A	B	C	D	E
Inch	mm	mm	mm	mm	mm
1	143	26	7	53	6
1 1/2	173	38.5	11.5	63	6

Working pressure: 1-3 bar  
Recommended pressure: 1.5-2 bar  
Max. working temperature: 95°C  
Max. ambient temperature: 140°C  
Other connection types and pin types available upon request



# STRAINERES 過濾器

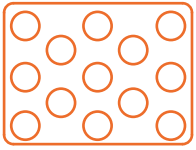

Punching (沖孔網)

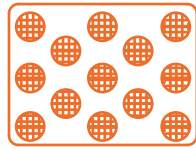

Wire net (平織網)

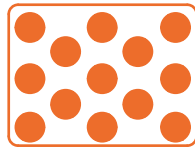

Notch wire (疊織網)

- Material: SS304 Or SS316L
- Punching: 1~6mm
- Mesh: 20~400
- P.D.Press(MPa): 0.05~0.2
- Type: Weld/Clamp/Male end

## Tube Straineres 直進直出過濾器

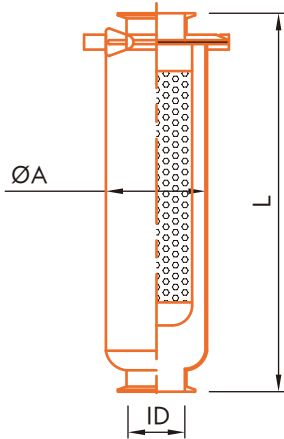

Size	ID	ØA	L
1.0"	22.1	101.6	380
1.5"	34.8	101.6	380
2.0"	47.5	101.6	380
2.5"	60.2	139.8	400
3"	72.9	139.8	450
4"	97.6	165.2	600

## L-Type Straineres 側進直出過濾器

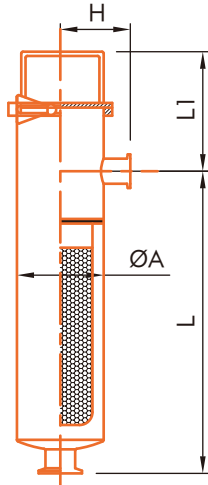

Size	ID	ØA	L	L1	H
1.0"	22.1	101.6	354	140	79
1.5"	34.8	101.6	354	140	82
2.0"	47.5	101.6	354	140	82
2.5"	60.2	101.6	300	140	105
3.0"	72.9	101.6	350	140	110
4.0"	97.6	139.8	440	140	155

## Y-Type Straineres Y型過濾器

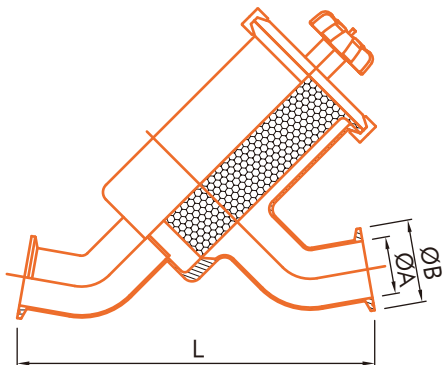

Size	ØA	ØB	L
1.0"	22.1	50.5	155
1.5"	34.8	50.5	192
2.0"	47.5	64	208
2.5"	60.2	77.5	252
3.0"	72.9	91	300



# PNEUMATIC SEAT VALVE 氣動座閥

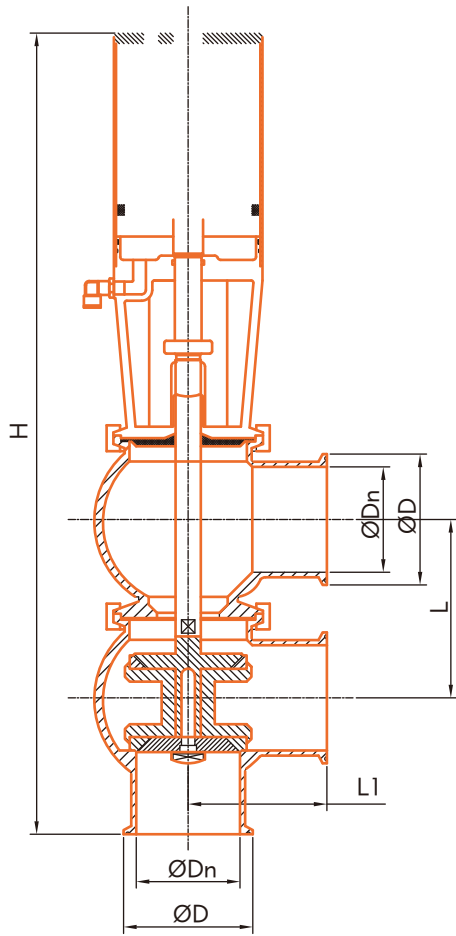

## Flow Type

F	L/L	T/T	L/T
Y	T	L	T/L

Size	ØD	ØDn	L	L1	H
1"	50.5	22.4	69	80	419
1.5"	50.5	35	69	80	419
2"	64	47.8	92	93	442
2.5"	77.5	60.2	100	98	480

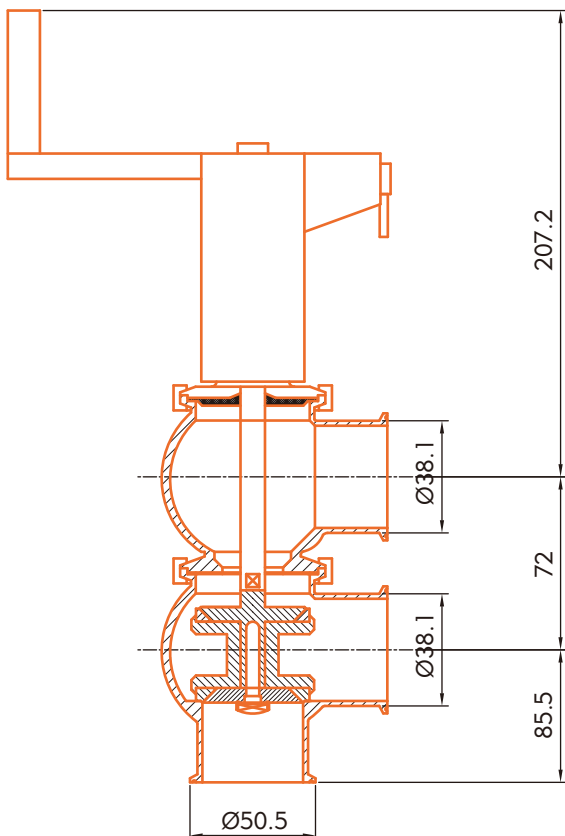



# SIGHT GLASS 玻璃視窗

## 3A Sight Glass Clamp End 夾式玻璃視窗

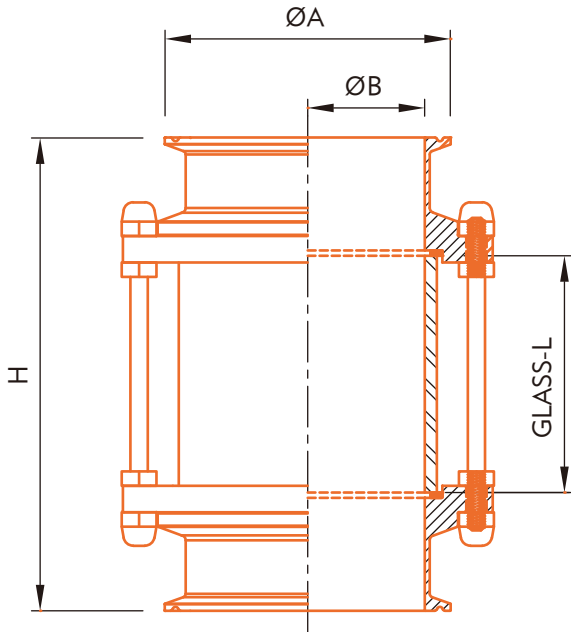

Size	ØA	ØB	H±2.0	GLASS L±2.0
1.0"	50.5	22.2	159.0	100.0
1-1/2"	50.5	34.8	163.5	100.0
2"	64.0	47.5	170.0	100.0
2-1/2"	77.5	60.2	173.3	100.0
3"	91.0	72.9	178.0	100.0
4"	119.0	97.4	196.0	100.0

## 3A Sight Glass Weld End 焊式玻璃視窗

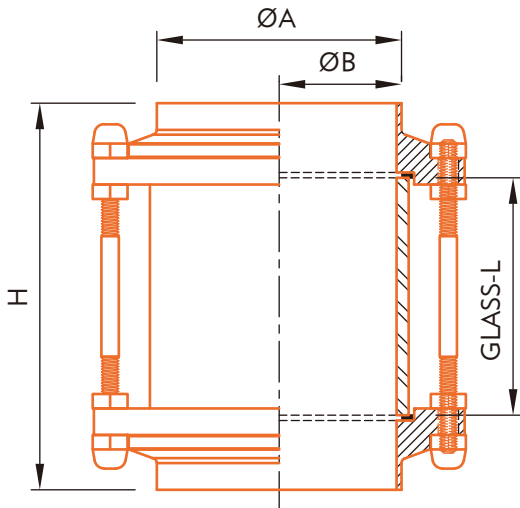

Size	ØA	ØB	H±2.0	GLASS L±2.0
1.0"	25.4	22.2	145.0	100.0
1-1/2"	38.1	34.8	145.0	100.0
2"	50.8	47.5	145.0	100.0
2-1/2"	63.5	60.2	150.0	100.0
3"	76.2	72.9	155.0	100.0
4"	101.6	97.4	158.0	100.0

# DIAPHRAGM VALVE 隔膜閥

## Surface treatment

All the valve cavity is fine polished by professional and technical personal. All the surface finish can be Ra0.4μm below. At the same time, we can also provide electropolish according to the needs of the users.

## Manual Diaphragm Valve

### 手動隔膜閥

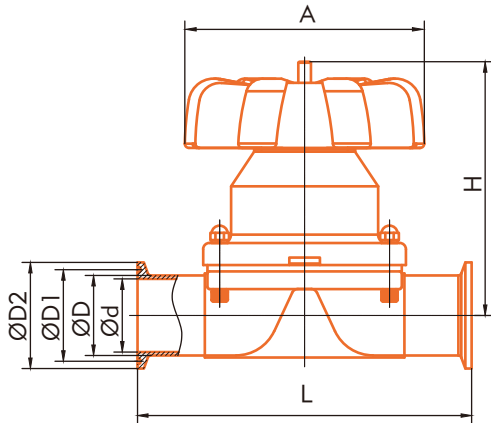

### Basic parameter

Specification	DN8-65
Diaphragm material	PTFE EPDM, PTFE+EPDM, EPDM
Body material	304, 316L
Body structure	Straight-through, three-way, u-body, L-shape, tank bottom, multi-channel
Bonnet material	304
Operating temperature	see it from the diaphragm
Working pressure	0-0.8Mpa PTFE EPDM 0-1.0Mpa PTFE+EPDM EPDM
Nominal pressure	1.6Mpa

NPS	DN	L	A	H <sub>開</sub>	H <sub>關</sub>	d	D	D1	D2
1/4"	DN8	86	33	92	87	6	8.4	20.2	25.0
3/8"	DN10	63.5/86	33	92	87	7.4	10	20.2	25.0
1/2"	DN15	86	33	92	87	9.4	12.7	20.2	25.0
3/4"	DN20	108	58	85	79	15.8	19.1	20.2	25.0
1"	DN25	127	90	102	91	22.1	25.4	20.2	50.5
1-1/4"	DN32	146	90	108	97	28.5	31.8	43.6	50.5
1-1/2"	DN40	159	114	122	110	34.8	38.1	43.6	50.5
2"	DN50	190	140	138	126	47.5	50.8	56.3	64.0
2-1/2"	DN65	216	140	142	130	59.5	63.5	70.6	77.5

## Pneumatic Diaphragm Valve

### 氣動隔膜閥

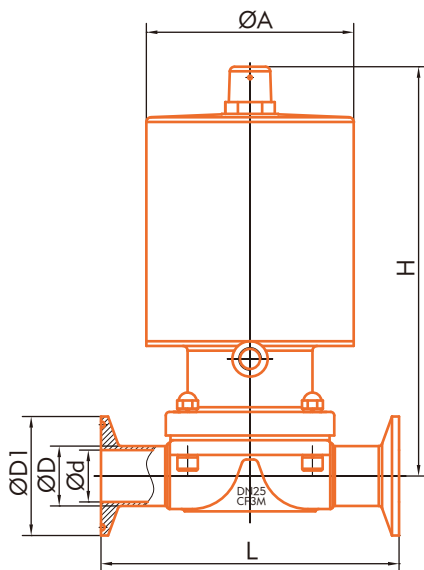

### Basic parameter

Specification	DN8-50
Diaphragm material	PTFE EPDM, PTFE+EPDM, EPDM
Body material	304, 316L
Body structure	Straight-through, three-way, u-body, L-shape, tank bottom, multi-channel
Hause of the actuator material	PA66-GF30
Driving pressure	0.4~0.6Mpa
Operating temperature	see it from the diaphragm
Working pressure	0-0.8Mpa PTFE EPDM 0-1.0Mpa PTFE+EPDM EPDM
Nominal pressure	1.6Mpa

NPS	DN	L	A	H	d	D	D2
3/8"	DN10	86	43	92	7.8	9.5	25.0
1/2"	DN15	86	43	92	9.4	12.7	25.0
3/4"	DN20	108	56	145	15.8	19.1	25.0
1"	DN25	127	88	175	22.1	25.4	50.5
1-1/4"	DN32	146	88	180	28.5	31.8	50.5
1-1/2"	DN40	159	109	213	34.8	38.1	50.5
2"	DN50	190	109	228	47.5	50.8	64.0
2-1/2"	DN65	216	109	235	60.2	63.5	77.5



# DIAPHRAGM VALVE 隔膜閥

## Tank Bottom Diaphragm Valve

### Basic parameter

Specification	DN20-50	
Diaphragm material	PTFE EPDM, PTFE+EPDM, EPDM	
Body material	304, 316L	
Body structure	With a sampling next to the tank bottom valve	
Actuator	Manual or pneumatic	
Operating temperature	see it from the diaphragm	
Working pressure	0-0.8Mpa	PTFE EPDM PTFE+EPDM
	0-1.0Mpa	EPDM
Nominal pressure	1.6Mpa	

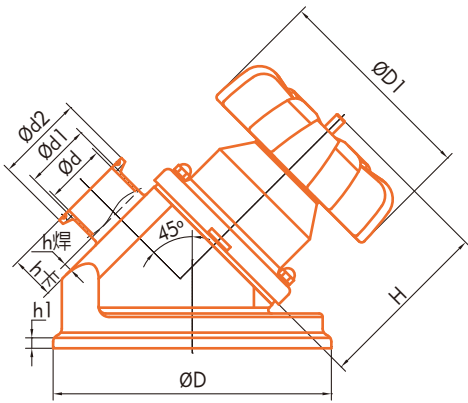

	D	D1	d	d1	d2(焊無)	H	h1	h卡	h焊
DN20	90	60	15.8	19.1	50.5	60	6	25	3
DN25	110	89	22.1	25.4	50.5	84	6	30	3
DN40	160	110	34.8	38.1	50.5	96	6	25	3
DN50	200	110	47.5	50.8	64	102	6	28	3

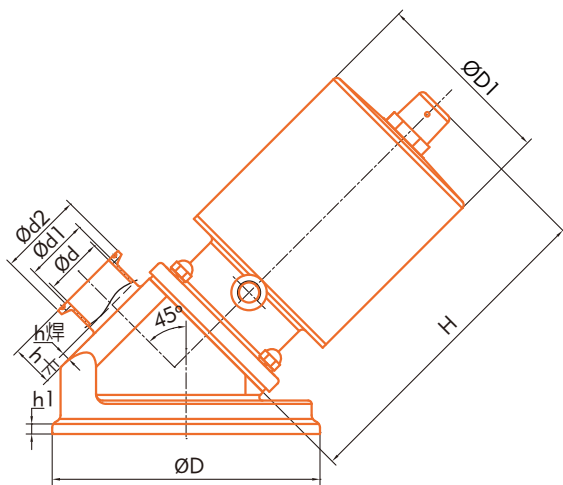

	D	D1	d	d1	d2(焊無)	H	h1	h卡	h焊
DN20	90	57	15.8	19.1	50.5	125	6	25	3
DN25	110	88	22.1	25.4	50.5	155	6	30	3
DN40	160	109	34.8	38.1	50.5	195	6	25	3
DN50	200	109	47.5	50.8	64	200	6	28	3

# DIAPHRAGM VALVE 隔膜閥

U-Type Diaphragm Valve 氣動U型三通隔膜閥

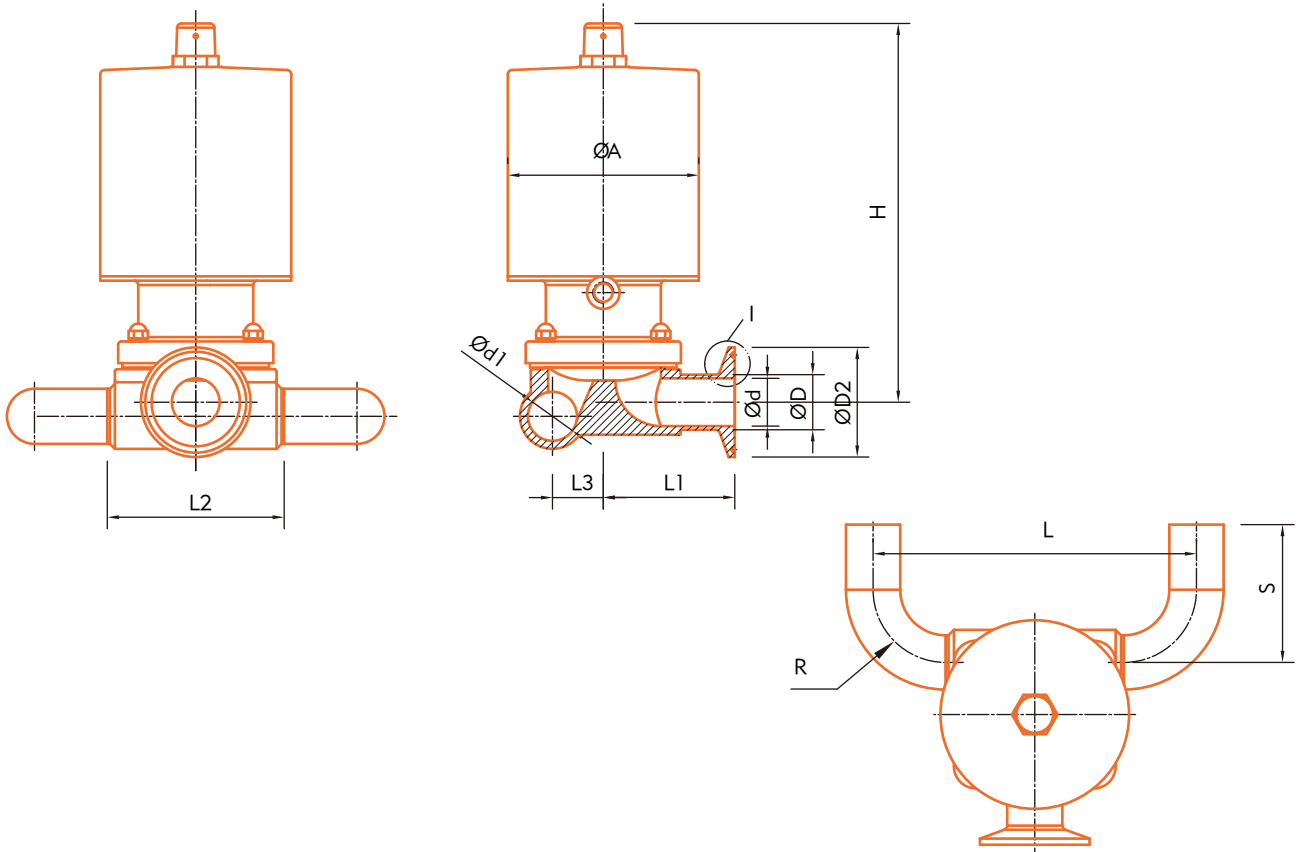

U-Type Diaphragm Valve 手動U型三通隔膜閥

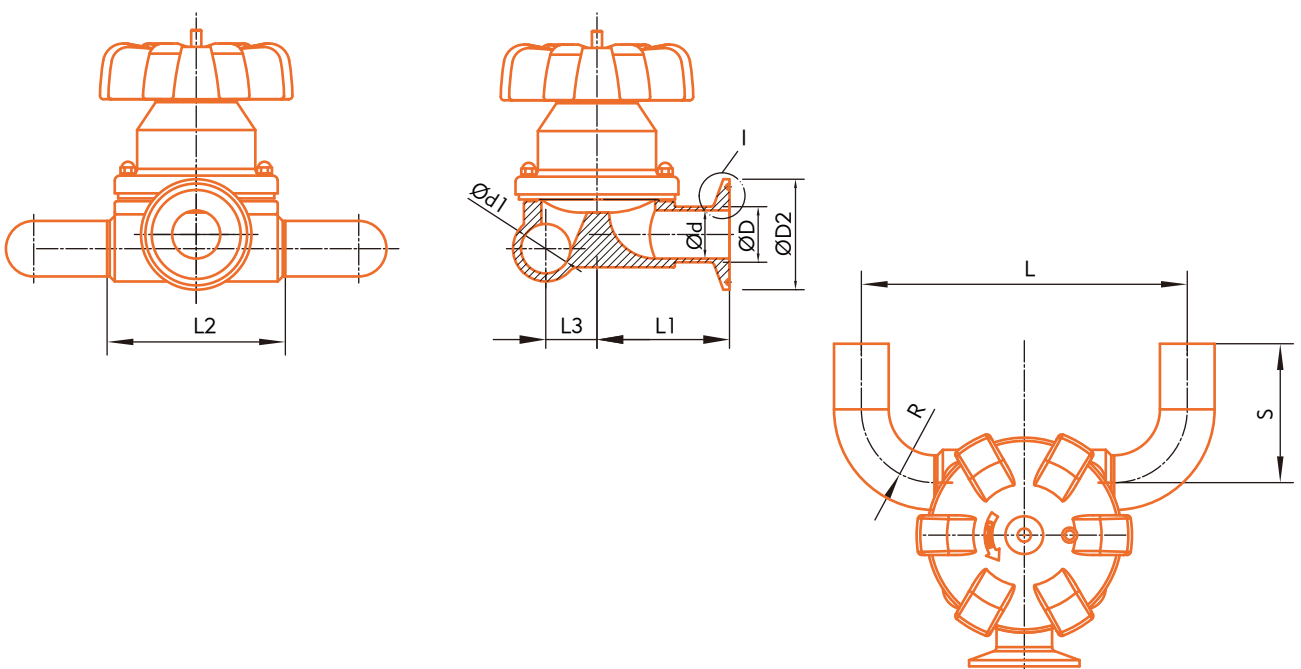



# DIAPHRAGM VALVE 隔膜閥

	R	L	L1	L2	L3	d	d1	D	D1	D2	S焊	S卡	M	A	H			
DN20X20	28.5	117	53	60	13.5	15.8	15.8	19.1	19.1	25/ 50.5	58.5	57.1	5	57	158			
DN25X20	33.5	149	60	82	24		22.1		25.4		63.5	62.1						
DN32X20	38	136	53	60	18		28.5		31.8		68	66.6						
DN40X20	48.5	179	60	82	26		34.8		38.1		78.5	77.1						
DN50X20	60.5	181	53	60			47.5		50.8		90.5	89.1						
DN65X20	83.5	227			31		59.5		63.5		123.5	112.1						
DN25X25	33.5	149	60	82	24	22.1	25.4	31.8	38.1	50.8	63.5	62.1	8	88	177			
DN32X25	38	158			25						28.5	68				66.6		
DN40X25	48.5	179			26						34.8	78.5				77.1		
DN50X25	60.5	203			34						47.5	90.5				89.1		
DN65X25	83.5	249			42						59.5	123.5				112.1		
DN32X32	38	158			25						28.5	31.8				38.1	50.8	68
DN40X32	48.5	179	28	34.8	78.5	77.1												
DN50X32	60.5	203	31	47.5	90.5	89.1												
DN40X40	48.5	207	72	110	34	34.8	38.1	50.8	63.5	78.5	77.1	10	109	213				
DN50X40	60.5	231													42	59.5	123.5	112.1
DN65X40	83.5	277													42	59.5	63.5	123.5
DN50X50	60.5	251	85	130	34	47.5	50.8	50.8	64	90.5	89.1	12	229					
DN65X50	83.5	297			42					59.5	63.5			123.5	112.1			
DN80X80	88.5	362	125	185	82	80	80	89	89	106	128.5	117.1	16	220	429			

# SMS UNION PARTS 由任

## SMS - 13R Round Nut 螺帽

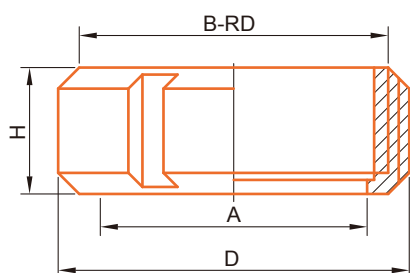

SIZE	A	D	B-RD	H
1"	32.5	51	RD40*1/6	19
1.5"	48.5	74	RD60*1/6	23
2"	61	84	RD70*1/6	24
2.5"	74	100	RD85*1/6	28
3"	87	114	RD98*1/6	30
4"	113	138	RD125*1/4	31

## SMS - 14 Weld Liner 無牙接頭

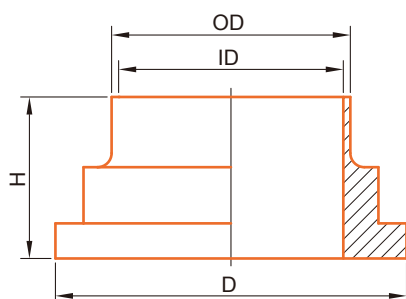

SIZE	OD	ID	D	H
1"	25	22.5	35.5	15.5
1.5"	38	35.5	55	16
2"	51	48.5	65	17
2.5"	63.5	60.5	80	17
3"	76.1	72.9	93	19
4"	101.6	97.6	118	19
4"	104	100	118	19

## SMS - 15 Weld Male 有牙接頭

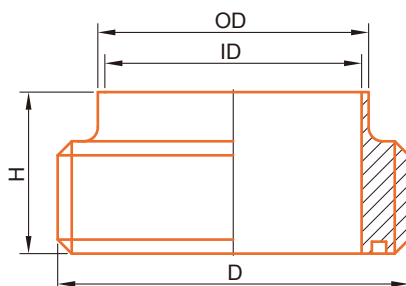

SIZE	OD	ID	D-RD	H
1"	25	22.5	RD40*1/6	19
1.5"	38	35.5	RD60*1/6	23
2"	51	48.5	RD70*1/6	23
2.5"	63.5	60.5	RD85*1/6	27
3"	76.1	72.9	RD98*1/6	27
4"	101.6	97.6	RD125*1/4	30
4"	104	100	RD125*1/4	30

## SMS Union Gasket 膠墊

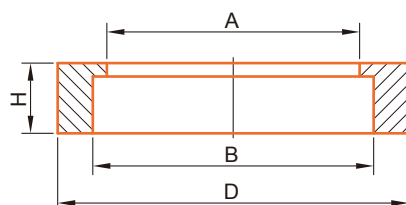

SIZE	A	B	D	H
1"	22.8	25.1	31.8	5.3
1.5"	35.8	38.1	47.8	5.3
2"	48.8	51.1	60.8	5.3
2.5"	60.8	63.6	73.3	5.3
3"	73.4	76.1	85.8	5.3
4"	98.2	101.6	113.8	5.3
4"	100.5	104	115.7	5.3

## SMS - 14B Blank Liner 盲板

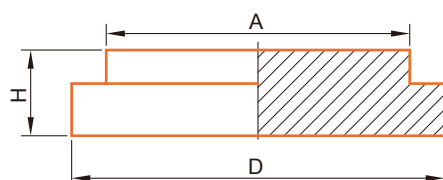

SIZE	A	D	H
1"	32	35.5	7.5
1.5"	47.9	55	8
2"	60.4	65	9
2.5"	73.5	80	9
3"	86.5	93	11
4"	112.5	118	11



# DIN UNION PARTS 由任

## DIN - 14 Weld Liner 無牙接頭

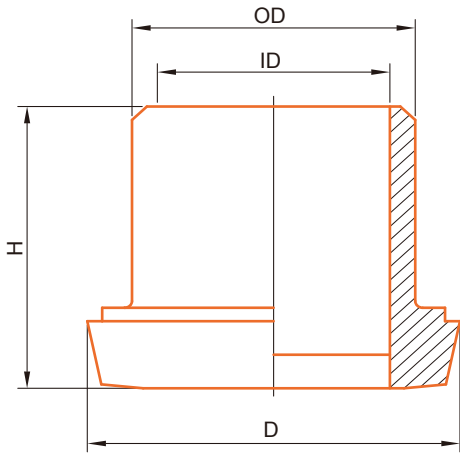

DN	OD	ID	D	H
10	15	10	22	17
15	21	16	28	17
20	25	20	36	18
25	31	26	44	22
32	37	32	50	25
40	43	38	56	26
50	55	50	68	28
65	72	66	86	32
80	87	81	100	37
90	95	89	111	35
100	106	100	120	44
125	132	125	149	34
150	157	150	175	37

## DIN - 15 Weld Male 有牙接頭

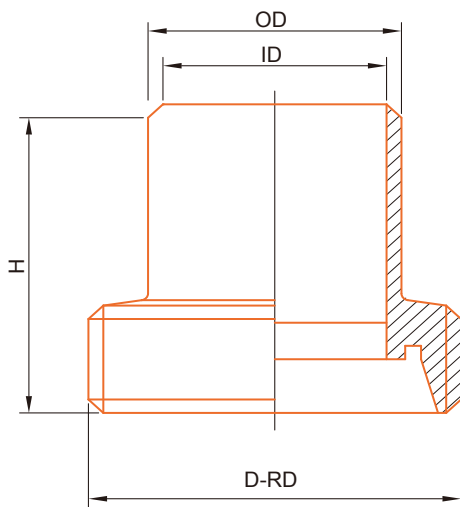

DN	OD	ID	D-RD	H
10	15	10	RD28*1/8	21
15	21	16	RD34*1/8	21
20	25	20	RD44*1/6	24
25	31	26	RD52*1/6	29
32	37	32	RD58*1/6	32
40	43	38	RD65*1/6	33
50	55	50	RD78*1/6	35
65	72	66	RD95*1/6	40
80	87	81	RD110*1/4	45
90	95	89	RD120*1/4	45
100	106	100	RD130*1/4	54
125	132	125	RD160*1/4	46
150	157	150	RD190*1/4	50



## DIN - 13R Round Nut 螺帽

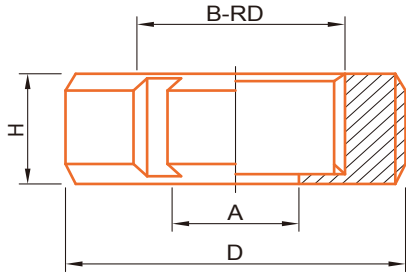

SIZE	A	D	B-RD	H
1"	36	63	RD52*1/6	21
1.5"	49	78	RD65*1/6	21
2"	62	92	RD78*1/6	22
2.5"	80	112	RD95*1/6	25
3"	94	127	RD110*1/4	30
4"	115	148	RD130*1/4	31

## DIN-14EB Weld Liner 無牙接頭 (英制)

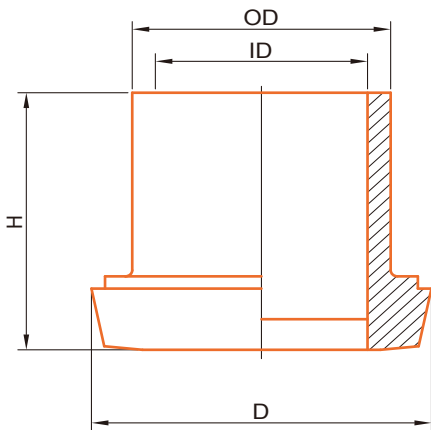

SIZE	OD	ID	D	H
1"	25.4	22.2	44	22
1.5"	38.1	34.9	56	26
2"	50.8	47.6	68	28
2.5"	63.5	60.3	86	32
3"	76.2	73	100	37
4"	101.6	97.6	121	44

## DIN-15EB Weld Male 有牙接頭 (英制)

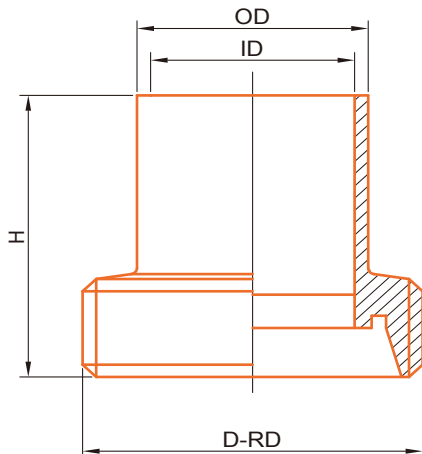

SIZE	OD	ID	D-RD	H
1"	25.4	22.2	RD52*1/6	29
1.5"	38.1	34.9	RD65*1/6	33
2"	50.8	47.6	RD78*1/6	35
2.5"	63.5	60.3	RD95*1/6	40
3"	76.2	73	RD110*1/4	45
4"	101.6	97.6	RD130*1/4	54



## DIN - 14 Blank Liner (Metrical) 盲板

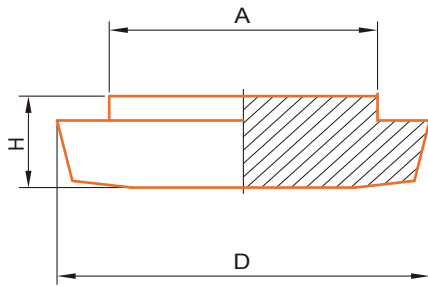

DN	A	D	H
10	18	22	9
15	24	28	9
20	30	36	11
25	35	44	13
32	41	50	13
40	48	56	13
50	61	68	14
65	79	86	16
80	93	100	16
100	114	120	20
125	137	149	22
150	163	175	24

## DIN Union Gasket 膠墊

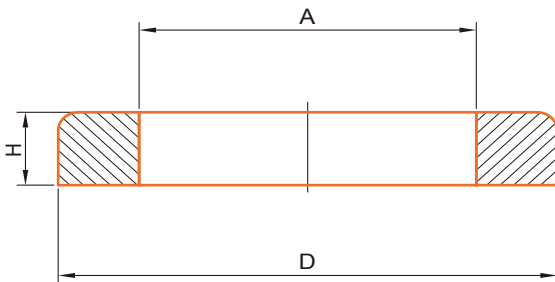

DN	A	D	H
10	12	20	4.5
15	18	26	4.5
20	23	33	4.5
25	30	40	5.0
32	36	46	5.0
40	42	52	5.0
50	54	64	5.0
65	71	81	5.0
80	85	95	5.0
100	104	114	6.0
150	130	142	7.0
150	155	167	7.0

## IDF-13H Hex Nut 螺帽

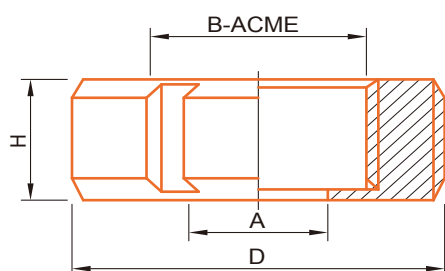

SIZE	A	D	B-ACME	H
1"	30.5	48	34.34*8T	30
1.5"	43.5	64	47.86*8T	30
2"	57	77	61.37*8T	30
2.5"	70.7	91	74.88*8T	30
3"	83.3	106	88.4*8T	30
4"	112	142	122.05*6T	35

## IDF - 14 Weld Liner 無牙接頭

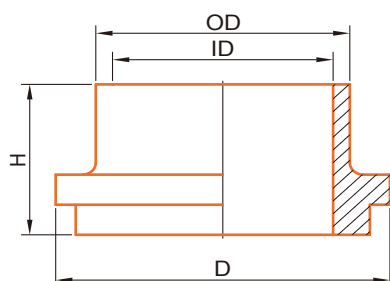

SIZE	OD	ID	D	H
1"	25.65	22.2	33.8	21.5
1.5"	38.35	34.9	47	21.5
2"	51.05	47.6	60.5	21.5
2.5"	63.75	60.3	74	21.5
3"	76.45	73	87.5	21.5
4"	101.85	97.6	120.6	30

## IDF - 15 Weld Male 有牙接頭

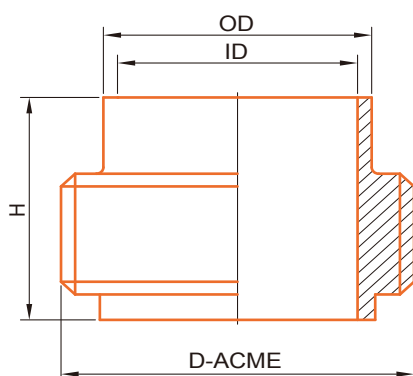

SIZE	OD	ID	D-ACME	H
1"	25.65	22.2	37.13*8T	21.5
1.5"	38.35	34.9	50.65*8T	21.5
2"	51.05	47.6	64.16*8T	21.5
2.5"	63.75	60.3	77.67*8T	21.5
3"	76.45	73	91.19*8T	21.5
4"	101.85	97.6	125.9*6T	30

## IDF Union Gasket 膠墊

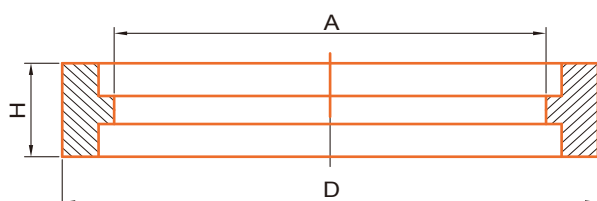

SIZE	A	D	H
1"	23.2	32.5	6
1.5"	35.9	46.0	6
2"	48.6	59.5	6
2.5"	61.3	73.2	6
3"	74	86.5	6
4"	98.6	119	6



## Weld Flange

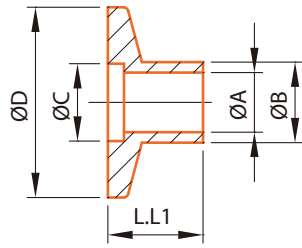

SIZE	ØA	ØB	ØC	ØD	L	L1
KF-10	9.4	12.7	12.2	30	12.7	40
KF-16	15.7	19.05	17.3	30	12.7	40
KF-25	22.1	25.4	26.2	40	12.7	40
KF-40	34.8	38.1	41.1	55	19.1	40
KF-50	46.5	50.8	52.3	75	19.1	40

## Socket Weld Flange

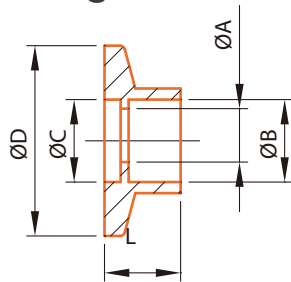

SIZE	ØA	ØB	ØC	ØD	L
KF-10	9.4	13.0	12.2	30.0	12.7
KF-16	15.7	19.3	17.3	30.0	12.7
KF-25	22.1	25.7	26.2	40.0	12.7
KF-40	34.8	38.4	41.1	55.0	12.7
KF-50	47.5	51.1	52.3	75.0	12.7

## Blank Flange

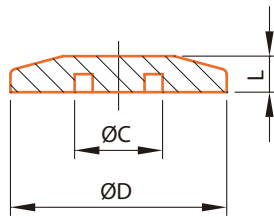

SIZE	ØC	ØD	L
KF-10	12.2	30	5.1
KF-16	17.3	30	5.1
KF-25	26.2	40	5.1
KF-40	41.1	55	5.1
KF-50	52.3	75	5.1

## ISO-Blank Flange

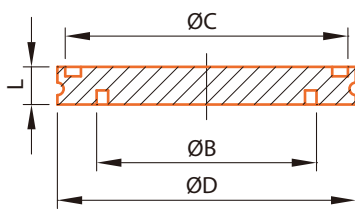

### Blank Flange

SIZE	ØB	ØC	ØD	L
ISO-63	70	90	95	12
ISO-80	83	105	110	12
ISO-100	102	125	130	12
ISO-160	153	175	180	12

## ISO-Bored Flange

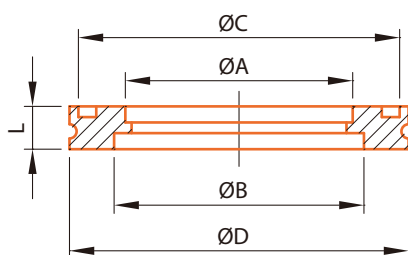

### Weld Flange

SIZE	ØA	ØB	ØC	ØD	L
ISO-63	63.7	70	90	95	12
ISO-80	76.4	83	105	110	12
ISO-100	101.8	102	125	130	12
ISO-160	152.9	153	175	180	12

# VACUUM COMPONENTS 真空管配件

KF-NW Centering Ring/  
KF-NW Centering Ring With Viton O-Ring

中心圈

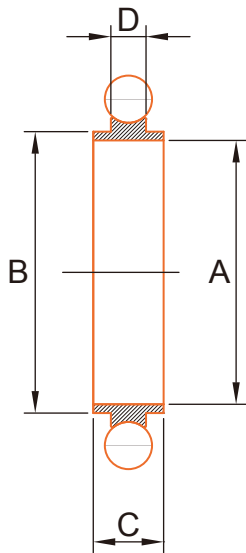

Model No.	C/R Material	O-ring Material	O-ring Size	A	B	C	D
KF-10-CRS-V	SUS304	VITON	AS-311	10	12	8	3.9
KF-16-CRS-V	SUS304	VITON	AS-314	16	17	8	3.9
KF-25-CRS-V	SUS304	VITON	AS-320	25	26	8	3.9
KF-40-CRS-V	SUS304	VITON	AS-326	40	41	8	3.9
KF-50-CRS-V	SUS304	VITON	AS-330	50	52	8	3.9
KF-10-CRA-V	AL	VITON	AS-311	10	12	8	3.9
KF-16-CRA-V	AL	VITON	AS-314	16	17	8	3.9
KF-25-CRA-V	AL	VITON	AS-320	25	26	8	3.9
KF-40-CRA-V	AL	VITON	AS-326	40	41	8	3.9
KF-50-CRA-V	AL	VITON	AS-330	50	52	8	3.9

Model No.	C/R Material	O-ring Material	O-ring Size	A	B	C	D
ISO-63-CRS-V	SUS304	VITON	AS-337	67	69.6	8	3.9
ISO-80-CRS-V	SUS304	VITON	AS-341	80	82.5	8	3.9
ISO-100-CRS-V	SUS304	VITON	AS-347	99	101.6	8	3.9
ISO-160-CRS-V	SUS304	VITON	AS-362	150	152.6	8	3.9
ISO-200-CRS-V	SUS304	VITON	AS-371	210	212.6	8	3.9
ISO-250-CRS-V	SUS304	VITON	AS-378	257.5	260.4	8	3.9
ISO-320-CRS-V	SUS304	VITON	AS-454	312	317.3	12	5.6
ISO-400-CRS-V	SUS304	VITON	AS-461	394	399.2	12	5.6
ISO-500-CRS-V	SUS304	VITON	AS-469	494	500.2	12	5.6
ISO-63-CRA-V	AL	VITON	AS-337	67	69.6	8	3.9
ISO-80-CRA-V	AL	VITON	AS-341	80	82.5	8	3.9
ISO-100-CRA-V	AL	VITON	AS-347	99	101.6	8	3.9
ISO-160-CRA-V	AL	VITON	AS-362	150	152.6	8	3.9
ISO-200-CRA-V	AL	VITON	AS-371	210	212.6	8	3.9
ISO-250-CRA-V	AL	VITON	AS-378	257.5	260.4	8	3.9
ISO-320-CRA-V	AL	VITON	AS-454	312	317.3	12	5.6
ISO-400-CRA-V	AL	VITON	AS-461	394	399.2	12	5.6
ISO-500-CRA-V	AL	VITON	AS-469	494	500.2	12	5.6



# VACUUM COMPONENTS 真空管配件

## KF-NW Centering Ring and Outer Ring With Viton O-Ring

中心圈+外圈

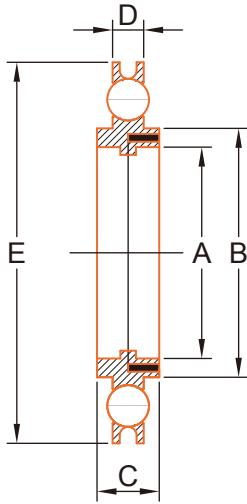

Model No.	O/R Material	C/R Material	O-ring Material	O-ring Size	A	B	C	D
KF-16-OCRS-S-V	SUS304	SUS304	VITON	5018	16	30.5	32.5	8
KF-25-OCRS-S-V	SUS304	SUS304	VITON	5028	25	40.5	42.5	8
KF-40-OCRS-S-V	SUS304	SUS304	VITON	5042	40	55.5	57.5	8
KF-50-OCRS-S-V	SUS304	SUS304	VITON	AS-330	50	75.5	77.5	8
KF-16-OCRA-S-V	AL	SUS304	VITON	5018	16	30.5	32.5	8
KF-25-OCRA-S-V	AL	SUS304	VITON	5028	25	40.5	42.5	8
KF-40-OCRA-S-V	AL	SUS304	VITON	5042	40	55.5	57.5	8
KF-50-OCRA-S-V	AL	SUS304	VITON	AS-330	50	75.5	77.5	8

Model No.	O/R Material	C/R Material	O-ring Material	O-ring Size	A	B	C	D	E
ISO-63-OCRA-S-V	AL	SUS304	VITON	AS-337	67	69.6	8	3.9	94
ISO-80-OCRA-S-V	AL	SUS304	VITON	AS-341	80	82.5	8	3.9	109
ISO-100-OCRA-S-V	AL	SUS304	VITON	AS-347	99	101.6	8	3.9	128
ISO-160-OCRA-S-V	AL	SUS304	VITON	AS-362	150	152.6	8	3.9	179
ISO-200-OCRA-S-V	AL	SUS304	VITON	AS-371	210	212.6	8	3.9	238
ISO-250-OCRA-S-V	AL	SUS304	VITON	AS-378	257.5	260.4	8	3.9	287
ISO-320-OCRA-S-V	AL	SUS304	VITON	AS-454	312	317.3	12	5.6	344
ISO-400-OCRA-S-V	AL	SUS304	VITON	AS-461	394	399.2	12	5.6	446
ISO-500-OCRA-S-V	AL	SUS304	VITON	AS-469	494	500.2	12	5.6	535
ISO-63-OCRA-A-V	AL	AL	VITON	AS-337	67	69.6	8	3.9	94
ISO-80-OCRA-A-V	AL	AL	VITON	AS-341	80	82.5	8	3.9	109
ISO-100-OCRA-A-V	AL	AL	VITON	AS-347	99	101.6	8	3.9	128
ISO-160-OCRA-A-V	AL	AL	VITON	AS-362	150	152.6	8	3.9	179
ISO-200-OCRA-A-V	AL	AL	VITON	AS-371	210	212.6	8	3.9	238
ISO-250-OCRA-A-V	AL	AL	VITON	AS-378	257.5	260.4	8	3.9	287
ISO-320-OCRA-A-V	AL	AL	VITON	AS-454	312	317.3	12	5.6	344
ISO-400-OCRA-A-V	AL	AL	VITON	AS-461	394	399.2	12	5.6	446
ISO-500-OCRA-A-V	AL	AL	VITON	AS-469	494	500.2	12	5.6	535

## KF-NW Single Pin Clamp

真空不鏽鋼手扣

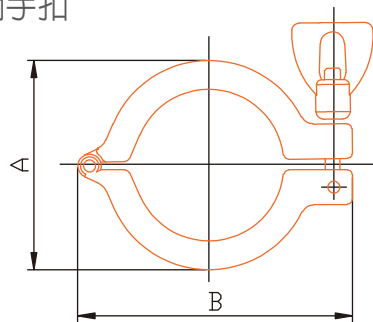

Size	Material	A	B
KF16	SS304	42.5	63
KF25	SS304	54	72
KF40	SS304	70	90
KF50	SS304	90	114

## 單釘鋁手扣

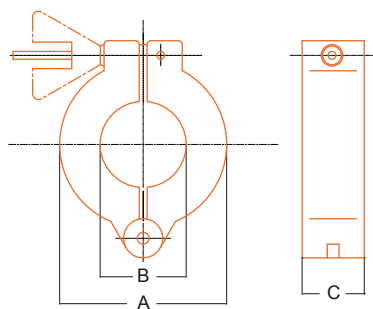

Size	Model	øA	D	L	T
KF16	ADC12	22	42.7	64	15.9
KF25	ADC12	32	52.7	74	15.9
KF40	ADC12	46	67.7	89	15.9
KF50	ADC12	61	89.4	109	15.9

## 雙釘鋁手扣

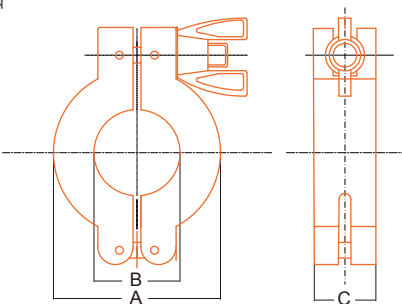

Size	Material	A	B	C
KF16	ADC12	61	45	16
KF25	ADC12	72	58	16
KF40	ADC12	92	72	16
KF50	ADC12	114	95	21

## Chain Clamp

鍊條式手扣

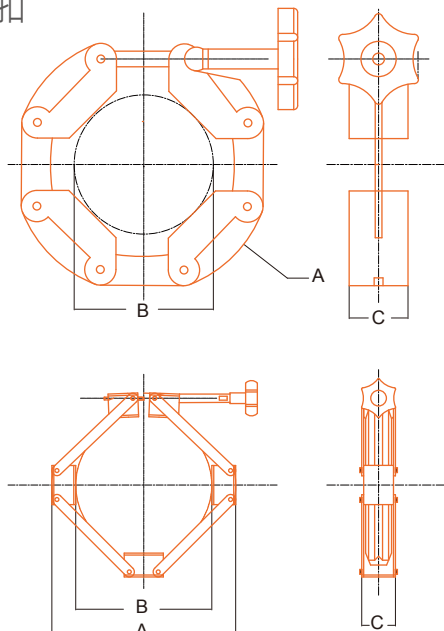

Size	A	B	C
KF16	22	56	20.5
KF25	32	66	20.5
KF40	46	80	20.5
KF50	69	100	20.5
KF63	78	112	20.5

Size	A	B	C
KF80	165	100	38.0
KF100	185	122	38.0
KF160	235	174	38.0



**生聖股份有限公司**  
**Sheng Sheng Metal Co., Ltd.**

彰化縣和美鎮輝南路121-3號  
No.121-3, Huinan Rd., Hemei Township,  
Changhua County 508, Taiwan (R.O.C.)  
TEL:+886-4-762-7200  
FAX:+886-4-762-7201  
E-mail:ssc@ssctw.com.tw



[www.ssctw.com.tw](http://www.ssctw.com.tw)